



INSTALLATION MANUAL

Converting Desk Clamp to Grommet Mount

with Installer-supplied Fasteners

CAUTION

Because applications vary, and the ultimate mounting method is out of Chief Manufacturing's control, it is imperative that the installer consults with the appropriate local construction professional to ensure that the Grommet Mount Base is mounted properly to handle applied loads.

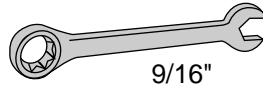
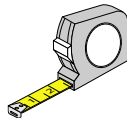
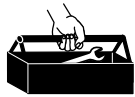
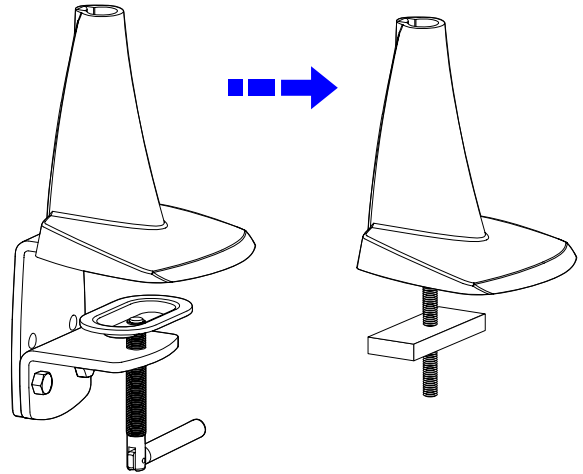

9/16"

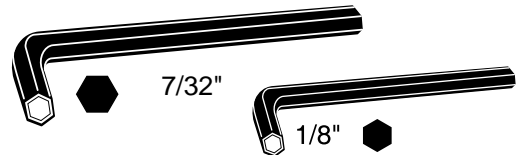

7/32"

1/8"

1

Remove lower Desk Clamp bracket assembly.

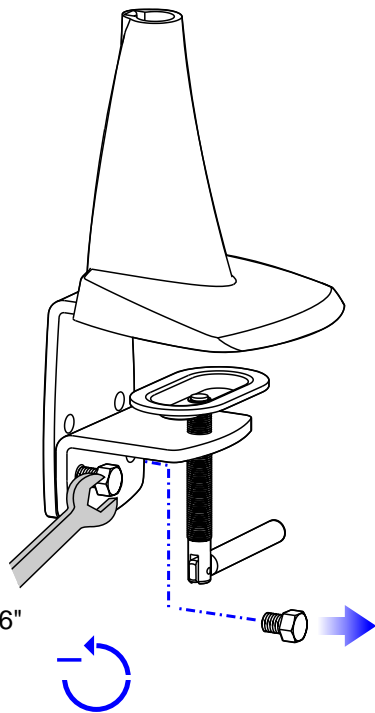

9/16"

1a

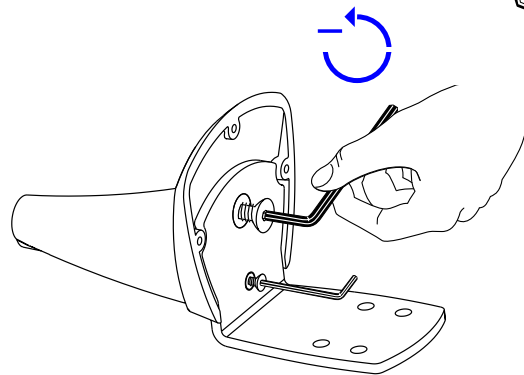

7/32"



1/8"

1b

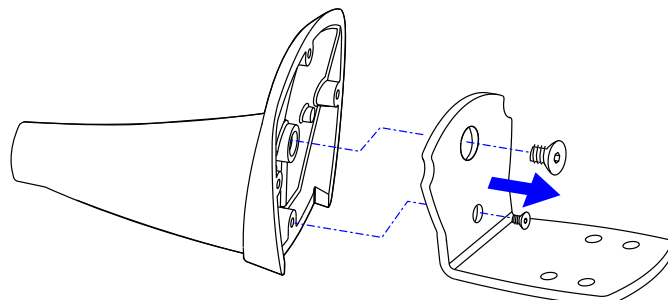

1c

Attach Base to worksurface with appropriately sized Threaded Rod, Steel Plate and Lock Nut. Refer to diagram below.

1. Determine Rod* length (x) by adding the following dimensions:

- 1" (thread engagement)
- y" (worksurface thickness)
- 1" (combined thickness of Steel Bar** and Lock Nut)

2. Steel Bar must extend beyond opening in worksurface at least 1/2".

* Rod Thread = 3/8-16 UNC, Grade 8 (coarse thread)

** Minimum thickness of Steel Bar must be 3/8". Example illustrated measures 1 1/4" wide x 4" long.

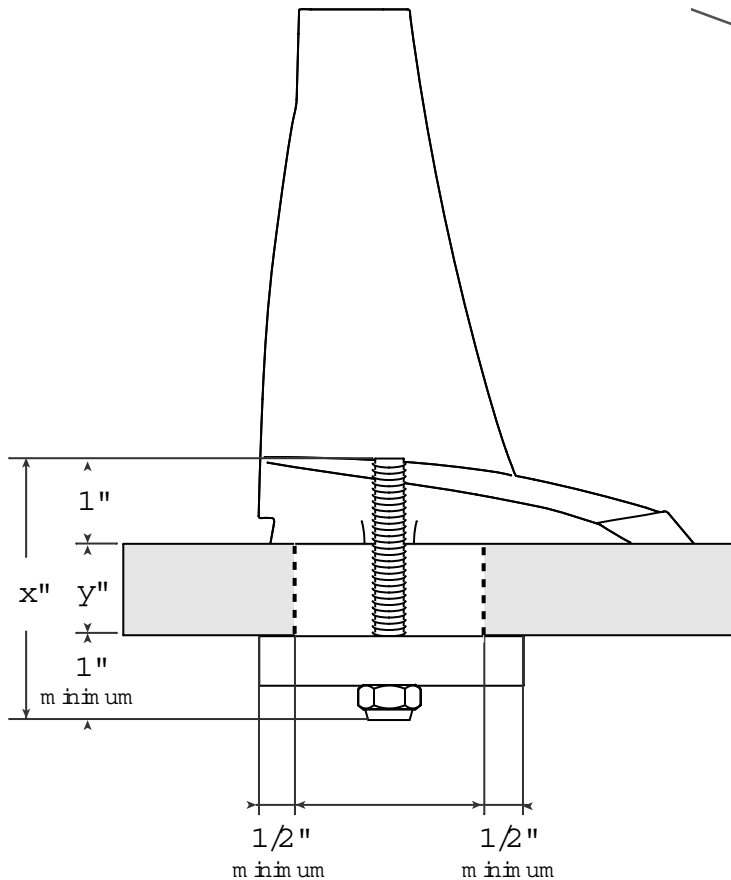
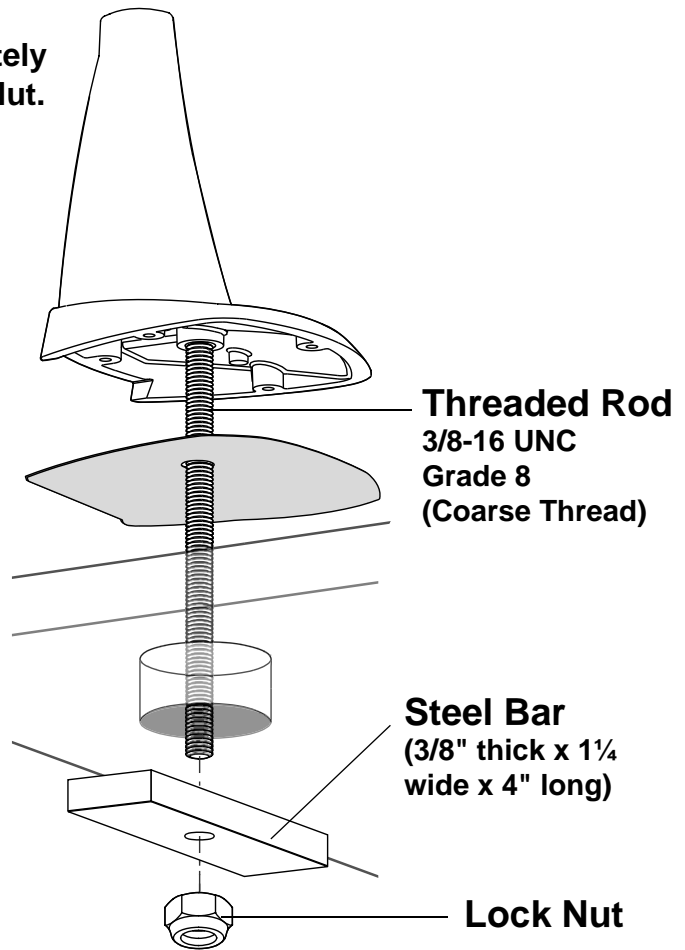

CAUTION

The mounting fasteners called out in this manual are minimum requirements based on average, expected loads. Installers are advised to consult the appropriate, local construction professional to ensure that requirements for their particular application are met.



Chief Manufacturing Inc.
12800 Hwy 13 S., Ste. 500
Savage, MN 55378 USA

Phone: 1-800-582-6480
Fax: 1-877-894-6918
www.chiefmfg.com