

# INSTALLATION INSTRUCTIONS

## ELEPHIL50-SM Static Wall Mount

Prior to assembly, unpack carton completely and verify contents. If you are missing any of the following components, please contact Technical Support at 1-800-776-5768.

- (1) PLASMA STATIC WALL MOUNT
- (8) MOUNTING BUTTONS, Yellow
- (8) SCREWS, M4 x 25mm Phillips Head Cap
- (2) FLAGS, Latching
- (2) WASHERS, Nylon .500" OD x .312" ID x .0312"
- (2) SCREWS, 10-24 x .5 FH Undercut
- (2) NUTS, Nylock 10-24

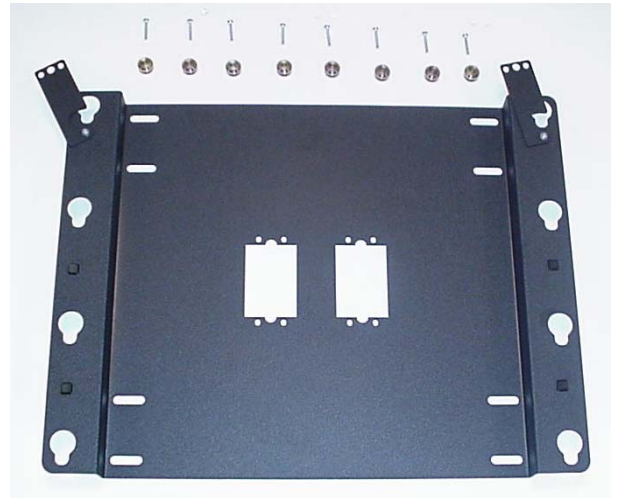

Figure 1

**CAUTION: PLASMA DISPLAYS ARE EXTREMELY FRAGILE!**

***READ INSTALLATION INSTRUCTIONS COMPLETELY BEFORE PROCEEDING***

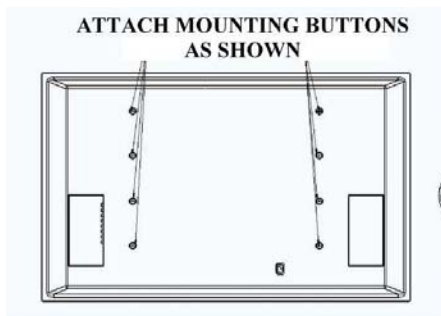

Figure 2

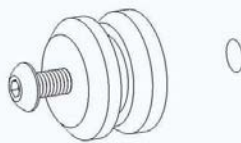

Figure 3

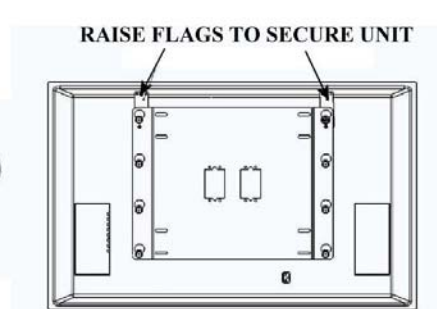

Figure 4

1. Attach mounting buttons to plasma using one Phillips head cap screw per mounting button (Figures 2 & 3).
2. Using two 10-24 x .5 FH undercut screws, Nylon washers between safety latch and mount, and 10-24 Nylock nuts, install the safety latches loose enough to move but tight enough to remain in place when raised.

**WARNING! Your mounting structure must be capable of supporting four times the combined weight of the plasma and the mount.**

3. Securely anchor the plasma static mount to the wall using wall studs or supporting framework.
4. Make sure the latching flags on the mount are lowered to the side before attempting to place the plasma on the mount.
5. With the aid of another person, lift the plasma display up to the mount. Align the mounting buttons on the plasma with the teardrop slots on the mount and set the plasma into place (Figure 4).
6. Raise latching flags to secure the plasma.