



## INSTALLATION INSTRUCTIONS

# FSA-1002 and KFSA-1002 FLAT PANEL DESK CLAMP ACCESSORY

Prior to assembly, unpack carton completely and verify contents.

If you are missing any of the following components, please contact Customer Service at 1-800/582-6480.

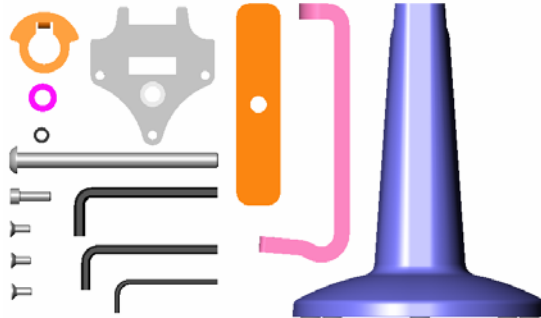

Figure 1

- |                        |                                      |                   |
|------------------------|--------------------------------------|-------------------|
| (1) Desk Clamp Casting | (1) Grommet Bracket                  | (1) 2.5mm Hex Key |
| (1) Thin Steel Washer  | (1) Rotational Stop Spacer           | (1) 5/32" Hex Key |
| (1) Rotational Stop    | (1) Button Head Cap Screw 4.0" Long  | (1) 3/16" Hex Key |
| (1) Clamp Bracket      | (1) Socket Head Cap Screw .625" Long |                   |
| (1) Alignment Bracket  | (3) Flat Head Cap Screw 10mm         |                   |

### **BEFORE PROCEEDING, READ INSTALLATION INSTRUCTIONS COMPLETELY**

#### **FLAT PANEL DISPLAYS ARE EXTREMELY FRAGILE.**

1. Using 3/16" hex key, remove the button head cap screw securing the monitor interface to the arm or other modular flat panel arm component (i.e. Wall plate).
2. Assemble base (see Figure 2).
3. Attach components (see Figure 3).
4. Using the 3/16" hex key, tighten the button head cap screw located at arm pivot point (see Figure 3 and Figure 4) until the desired amount of pivoting friction is achieved.
5. Refer to FCD manual for further installation instructions.

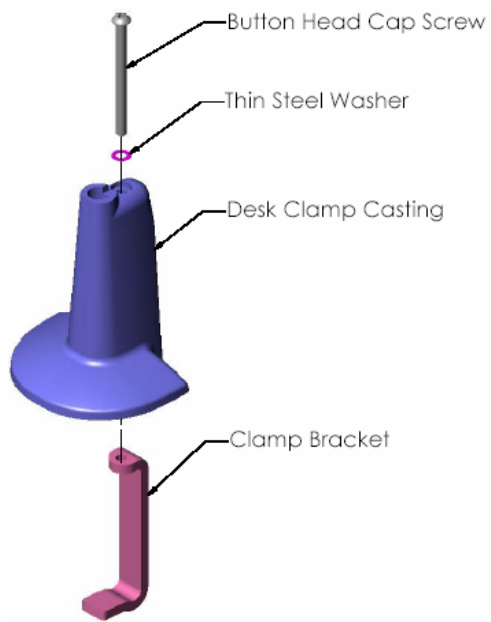

Figure 2

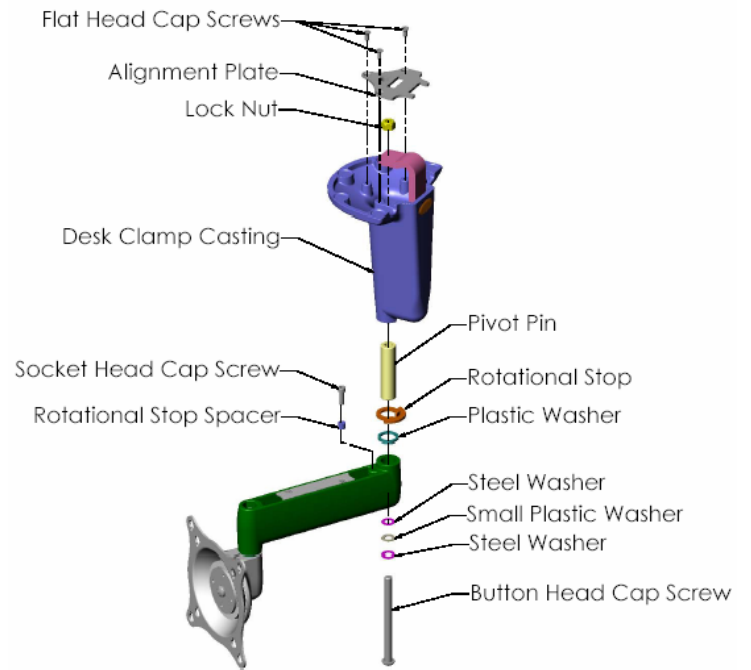

Figure 3

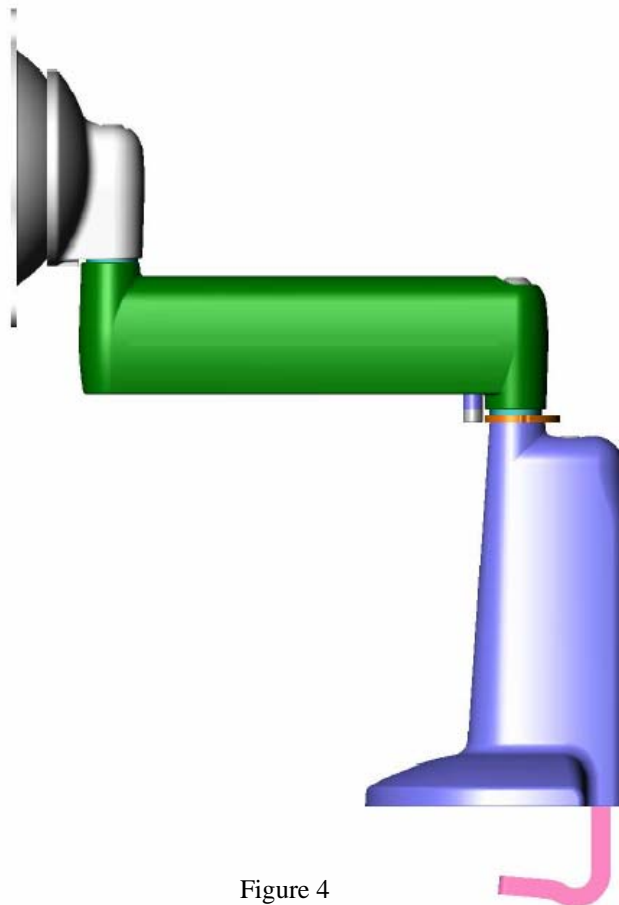

Figure 4