

INSTALLATION INSTRUCTIONS

Dual Screen Adapter Accessory

Model MAC-161

The MAC-161 Dual Screen Adapter is used to mount 2 MFP displays side-by-side on a PPC Cart.

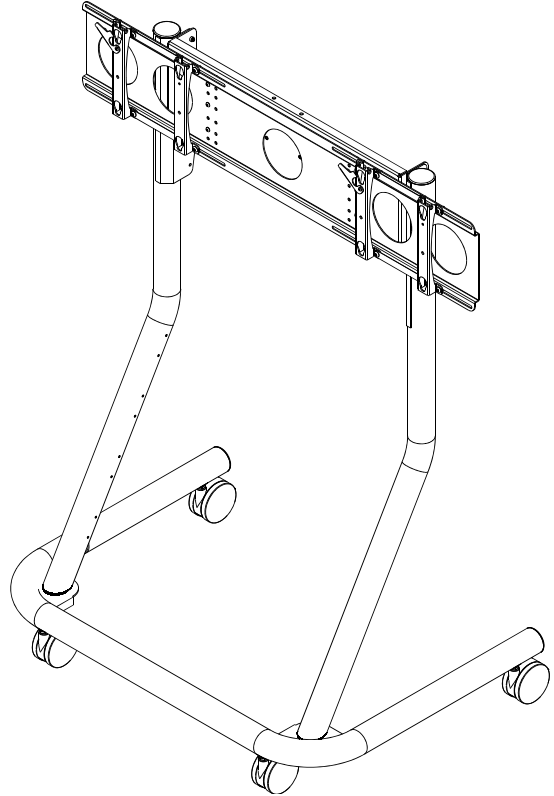

BEFORE YOU BEGIN

⚠ CAUTION!

To prevent damage to the mount, which could affect or void the Factory warranty, and to the equipment that will be attached to it, thoroughly study all instructions and illustrations before you begin the installation.

- If you have any questions about this installation, contact Chief Manufacturing at 1-800-582-6480.



CHIEF MANUFACTURING INC.
1-800-582-6480 952-894-6280 FAX 952-894-6918
8401 EAGLE CREEK PARKWAY, STE 700
SAVAGE, MINNESOTA 55378 USA

8814-000005 (Rev. A)
©2007 Chief Manufacturing
www.chiefmfg.com
09/07

INTRODUCTION

TOOLS REQUIRED FOR INSTALLATION

- Phillips screwdrivers, No. 1 and No. 2 tip
- 1/8" Hex Key (provided)
- 3/16" Hex Key (provided)
- 5/32" Hex Key (provided)

NOTE: Other tools may be required depending on the method of installing the unit in the ceiling.

INSPECT MOUNT BEFORE ASSEMBLY

Carefully inspect all components for shipping damage . If damage is apparent, call your carrier claims agent and do not continue with installation until the carrier has reviewed the damage. (see Figure 1)

Table 1: Parts

Ref.	Description	QTY
10	PLATE, Mounting, Dual MFP	1
20	UPRIGHT, MSR	4
30	BAR, Spacer	4
40	FLAG, Locking	2
50	SCREW, Cap, Button Head, 5/16-18 x 5/8"	16
60	NUT, Lock, 5/16-18	16
70	SCREW, Cap, Button Head, 1/4-20 x 5/8"	6
80	NUT, Lock, 1/4-20	6
90	SCREW, Cap, Button Head, 10-24 x 1/2"	2
100	NUT, Lock, 10-24	2
110	SPACER, Nylon,	2
120	KEY, Hex, 1/8"	1
130	KEY, Hex, 3/16"	1
140	KEY, Hex, 5/32"	1

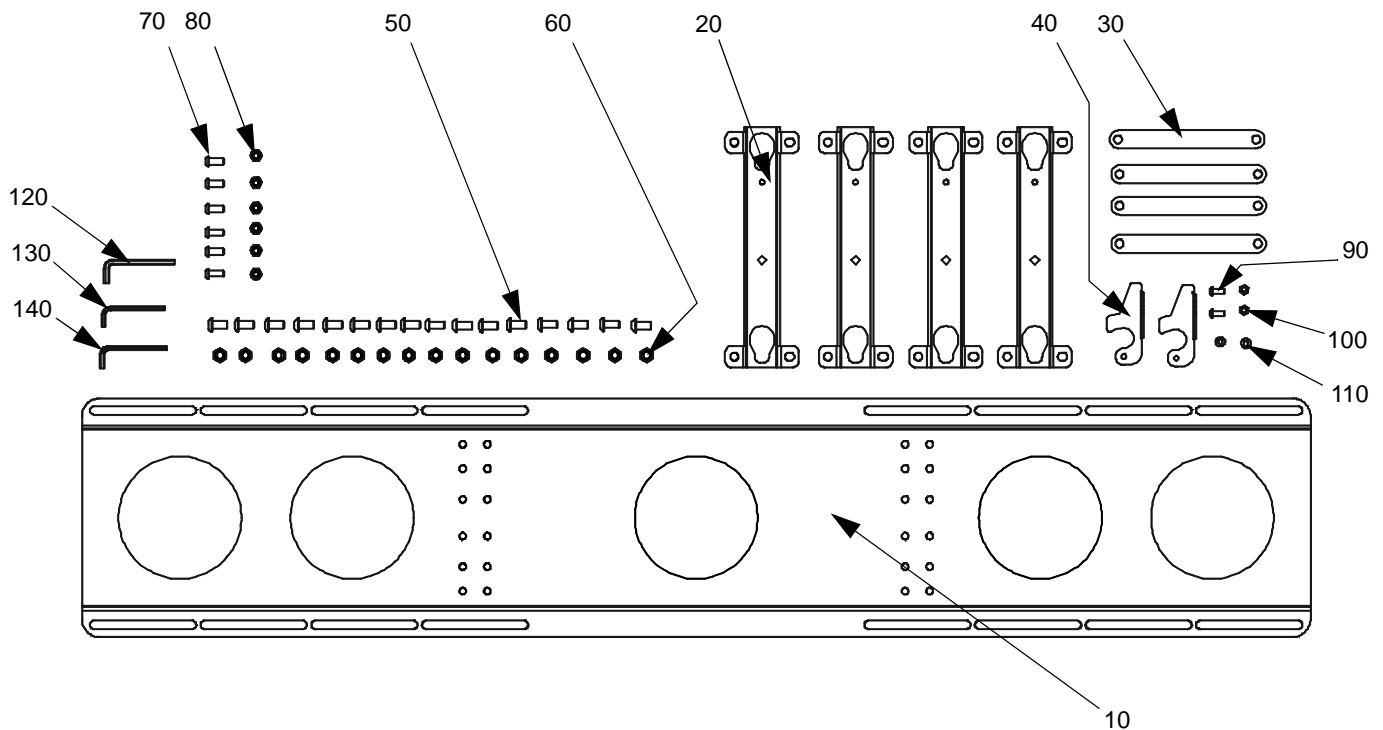

Figure 1:

INSTALLATION

Assemble latching flags to uprights

1. Assemble one BHCS (90) through latching flag (40) and one spacer (110). (see Figure 2)
2. Slide BHCS (90) through upright (20).
3. Secure latching flag (40) to upright (20) using one locknut (100). (see Figure 2)

NOTE: Two latching flags require assembly. When finished with the assembly of the first latching flag, repeat steps 1 through 3 above to assemble the second flag.

Assemble Uprights to Mounting Plate

1. Place uprights (20) against mounting plate (10) so that mounting holes in uprights (20) are aligned with upper and lower slots in mounting plate (10).

⚠ CAUTION!

IMPROPER INSTALLATION CAN LEAD TO THE MOUNT FALLING. Make certain the uprights are installed with smaller area of teardrop mounting holes facing down and latching flag is located at top.

2. Place two spacer bars (30) between uprights (20) and align mounting holes in spacers (30) with mounting holes in uprights (20).
3. Secure uprights (20) to mounting plate (10) using eight BHCS (50) and eight lock nut (60).

NOTE: DO NOT tighten hardware at this time.

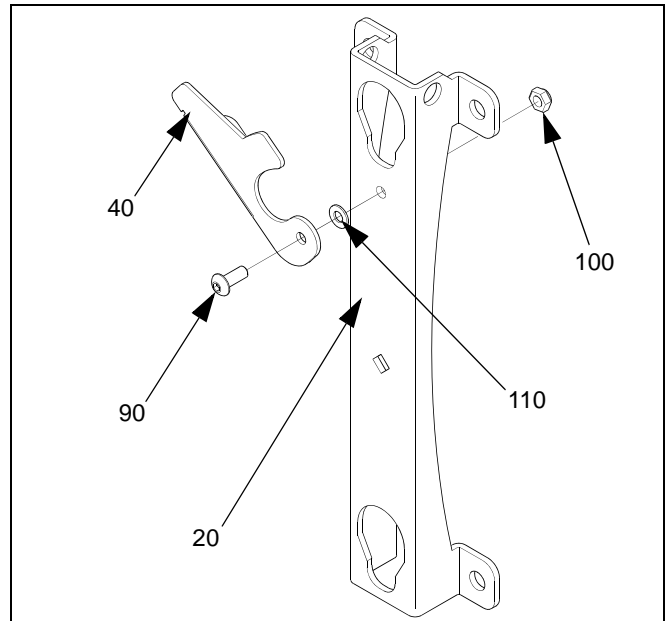

Figure 2:

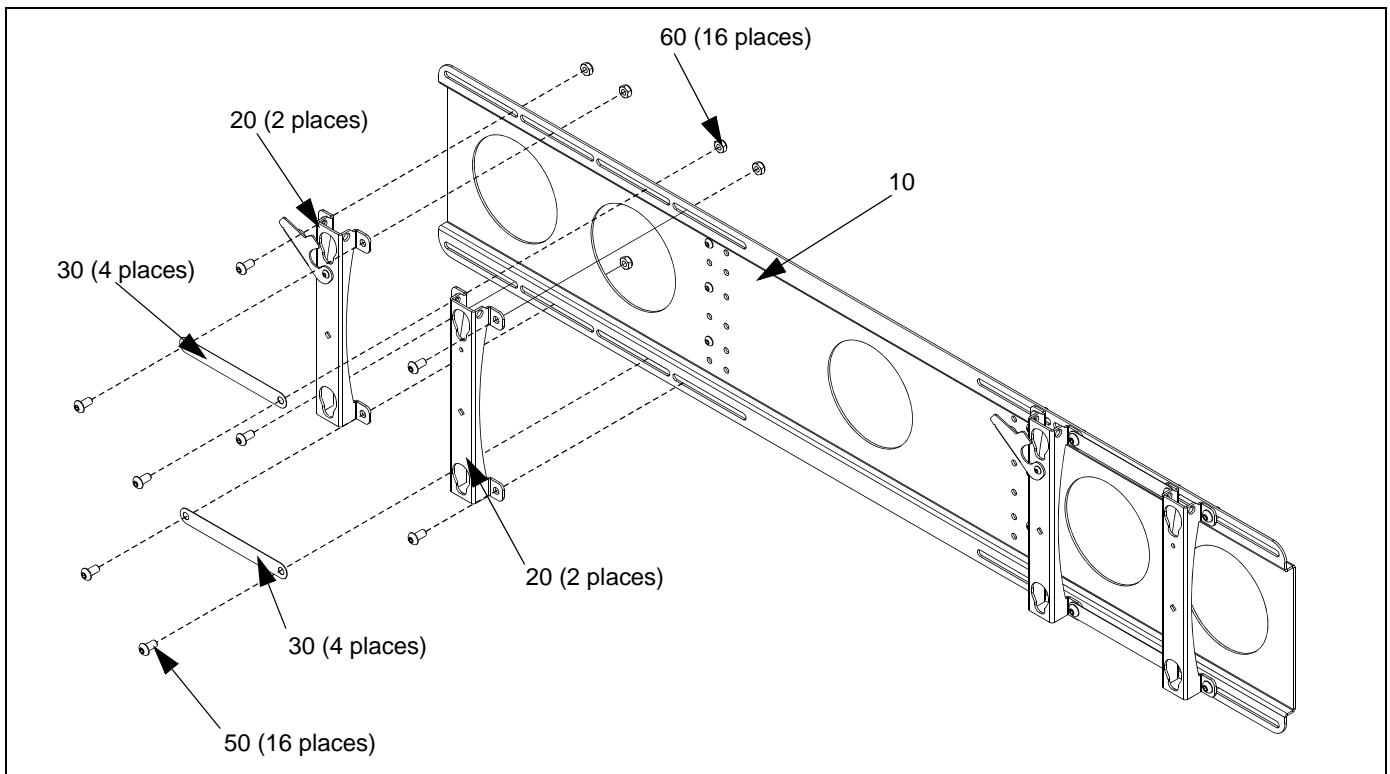

Figure 3:

Locate The Displays

In order to install the uprights, the distance between displays must be determined prior to assembling the uprights and spacers to the backplate.

1. Install mounting buttons and/or interface bracket to displays following the installation instructions included with the bracket.
2. Lay mounting plate with uprights on back.
3. Make sure locking flags are in the open position. (see Figure 4)
4. Lay displays down one at a time, sliding mounting buttons on display into teardrop mounting holes in uprights. (see Figure 6)
5. Slide displays right or left and reposition uprights until displays are properly positioned.
6. Carefully remove displays one at a time and fully tighten all hardware securing uprights to mounting plate. (see Figure 3)

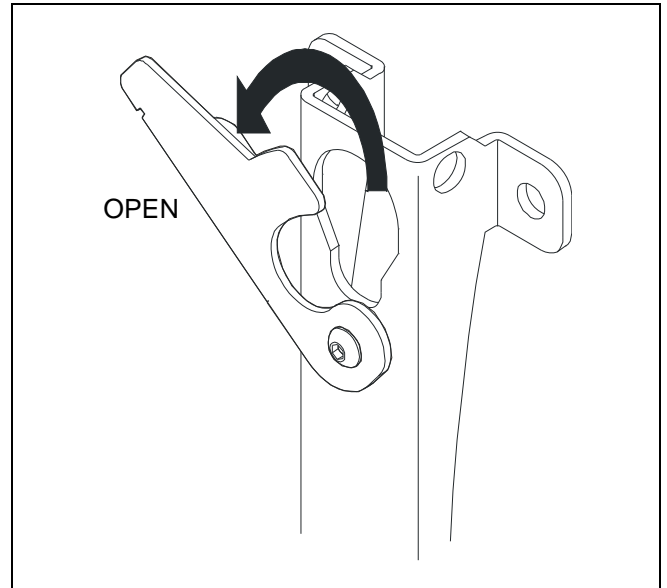

Figure 4:

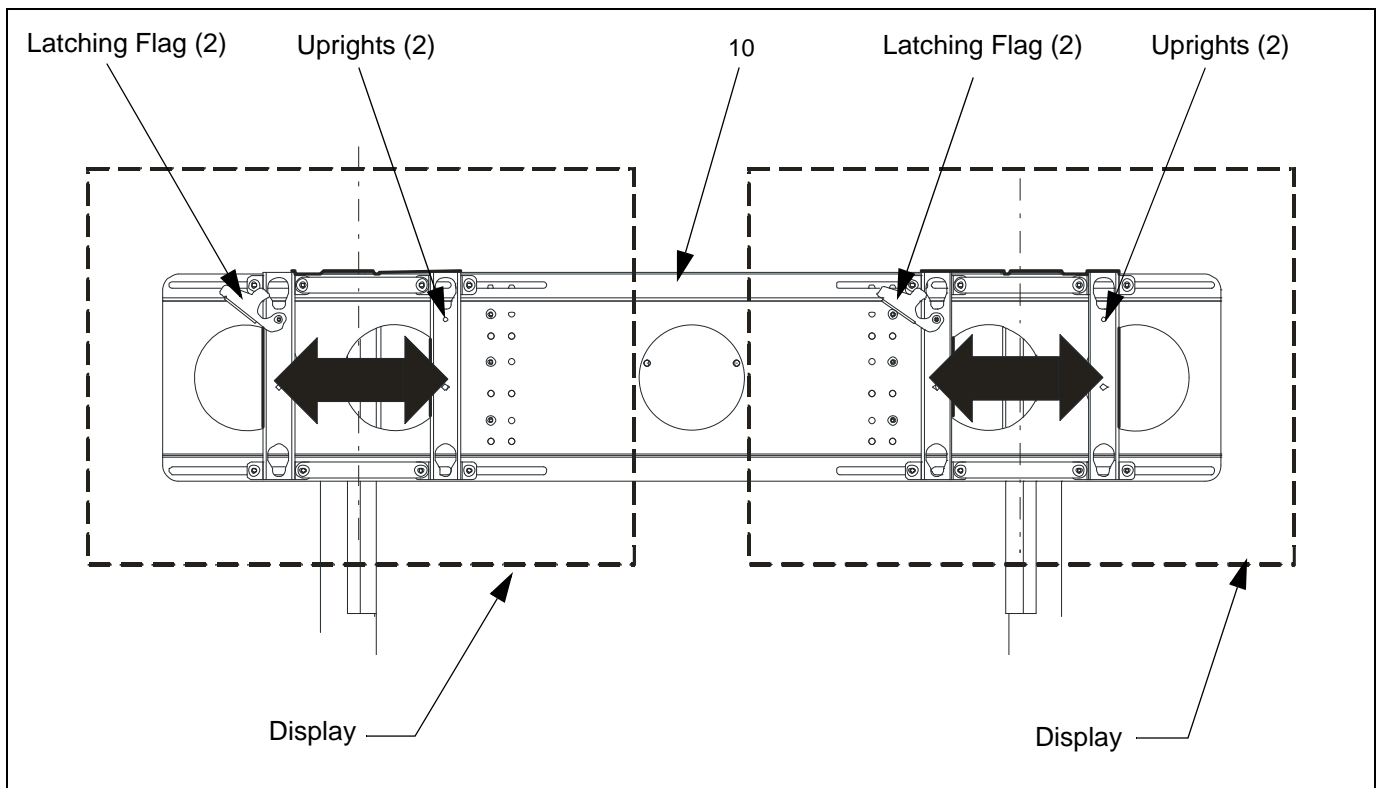

Figure 5:

Assemble Mounting Plate with Uprights to Stand

1. Align mounting holes in mounting plate with mounting holes in stand. (see Figure 6)
2. Install six BHCS (70) through mounting plate and stand. (see Figure 6)
3. Secure mounting plate to stand using six locknuts (80). (see Figure 6)
4. Tighten all hardware.

Install Displays

1. Install displays following the installation instructions provided with display interface bracket.

⚠ WARNING!

IMPROPER INSTALLATION CAN LEAD TO DISPLAY FALLING CAUSING SEVERE PERSONAL INJURY OR DAMAGE TO EQUIPMENT! Make mounting buttons on display are properly seated in teardrop mounting holes in uprights and latching flags are properly closed after installing displays!

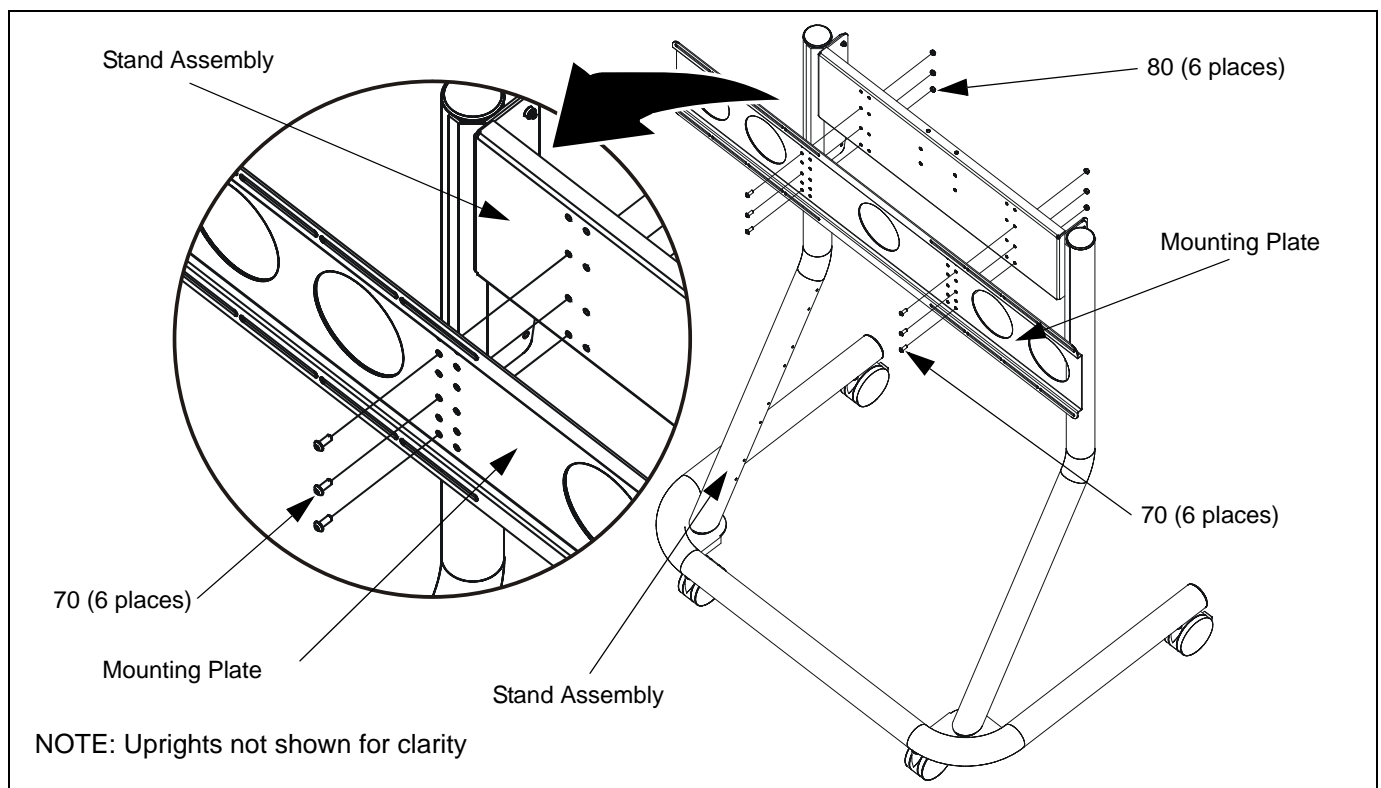
**Figure 6:**

