

# INSTALLATION INSTRUCTIONS

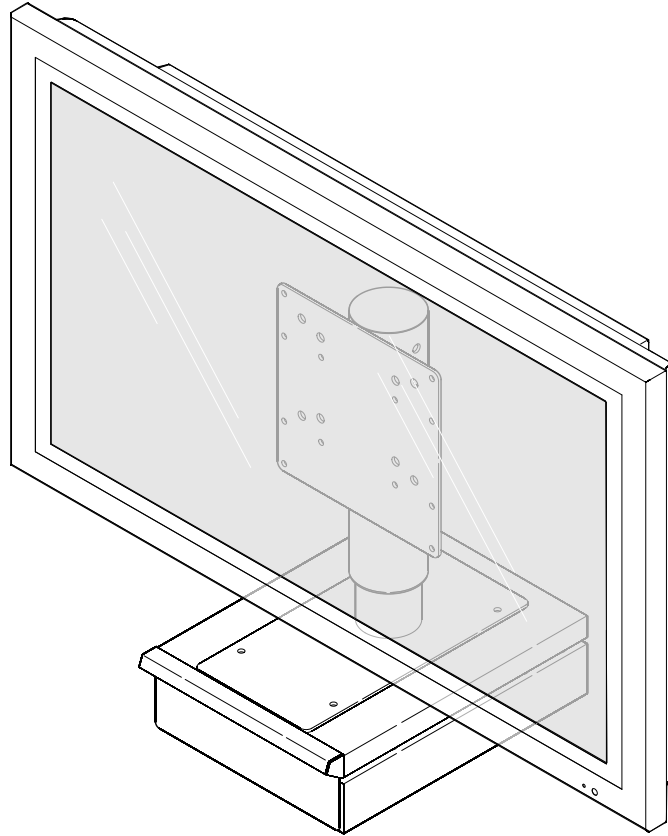

---

## Pull-Out Cabinet Mount

---

## DISCLAIMER

CSAV, Inc., and its affiliated corporations and subsidiaries (collectively, "CSAV"), intend to make this manual accurate and complete. However, CSAV makes no claim that the information contained herein covers all details, conditions or variations, nor does it provide for every possible contingency in connection with the installation or use of this product. The information contained in this document is subject to change without notice or obligation of any kind. CSAV makes no representation of warranty, expressed or implied, regarding the information contained herein. CSAV assumes no responsibility for accuracy, completeness or sufficiency of the information contained in this document.



## IMPORTANT WARNINGS AND CAUTIONS!



**WARNING:** A WARNING alerts you to the possibility of serious injury or death if you do not follow the instructions.



**CAUTION:** A CAUTION alerts you to the possibility of damage or destruction of equipment if you do not follow the corresponding instructions.



**WARNING:** Failure to read, thoroughly understand, and follow all instructions can result in serious personal injury, damage to equipment, or voiding of factory warranty! It is the installer's responsibility to make sure all components are properly assembled and installed using the instructions provided.



**WARNING:** Failure to provide adequate structural strength for this component can result in serious personal injury or damage to equipment! It is the installer's responsibility to make sure the structure to which this component is attached can support five times the combined weight of all equipment. Reinforce the structure as required before installing the component.



**WARNING:** Exceeding the weight capacity can result in serious personal injury or damage to equipment! It is the installer's responsibility to make sure the combined weight of all components placed on the mount does not exceed 130lbs (59kg).

**LEGEND**

	<b>Tighten Fastener</b>
	Apretar elemento de fijación
	Befestigungsteil festziehen
	Apertar fixador
	Serrare il fissaggio
	Bevestiging vastdraaien
Serrez les fixations	

	<b>Pencil Mark</b>
	Marcar con lápiz
	Stiftmarkierung
	Marcar com lápis
	Segno a matita
	Potloodmerkten
Marquage au crayon	

	<b>Loosen Fastener</b>
	Aflojar elemento de fijación
	Befestigungsteil lösen
	Desapertar fixador
	Allentare il fissaggio
	Bevestiging losdraaien
Desserrez les fixations	

	<b>Drill Hole</b>
	Perforar
	Bohrloch
	Fazer furo
	Praticare un foro
	Gat boren
Percez un trou	

	<b>Phillips Screwdriver</b>
	Destornillador Phillips
	Kreuzschlitzschraubendreher
	Chave de fendas Phillips
	Cacciavite a stella
	Kruiskopschroevendraaier
Tournevis à pointe cruciforme	

	<b>Adjust</b>
	Ajustar
	Einstellen
	Ajustar
	Regolare
	Afstellen
Ajuster	

	<b>Open-Ended Wrench</b>
	Llave de boca
	Gabelschlüssel
	Chave de bocas
	Chiave a punte aperte
	Steeksleutel
Clé à fourche	

	<b>Remove</b>
	Quitar
	Entfernen
	Remover
	Rimuovere
	Verwijderen
Retirez	

	<b>By Hand</b>
	A mano
	Von Hand
	Com a mão
	A mano
	Met de hand
À la main	

	<b>Optional</b>
	Opcional
	Optional
	Opcional
	Opzionale
	Optie
En option	

	<b>Hex-Head Wrench</b>
	Llave de cabeza hexagonal
	Sechskantschlüssel
	Chave de cabeça sextavada
	Chiave esagonale
	Zeskantsleutel
Clé à tête hexagonale	

	<b>Security Wrench</b>
	Llave de seguridad
	Sicherheitsschlüssel
	Chave de segurança
	Chiave di sicurezza
	Veiligheidssleutel
Clé de sécurité	

### TOOLS REQUIRED FOR INSTALLATION AND PARTS

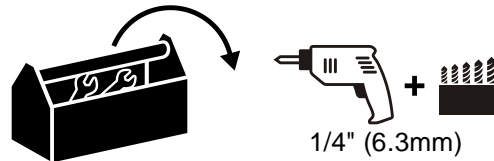
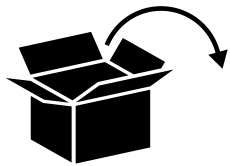

(6) Button Head Bolt - a



(6) 1/4 20 Nut - b

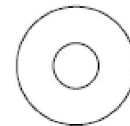

(6) Washer - c



(4) M8 Nut - d

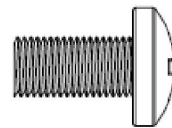

(4) M8 x 16 Bolt - e



(4) M8 Lock Washer - f

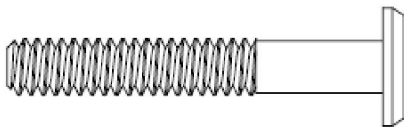

(4) Furniture Bolt - g



(4) Wood Screw - h



(1) Allen Key - i

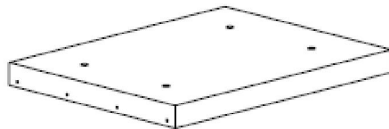

(1) Base - j

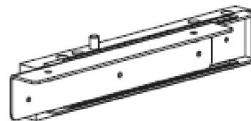

(1) Left Glide - k

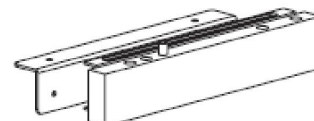

(1) Right Glide - l

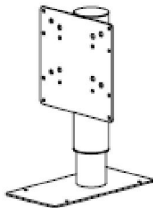

(1) Top Assembly - m \*



(1) Handle - n

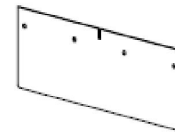

(1) Front Cover - o



(4) M4 x 10 Bolt - p



(4) M4 x 30 Bolt - q

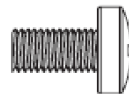

(4) M6 x 12 Bolt - r



(4) M6 x 35 Bolt - s



(4) M4 Lock Washer - t



(4) M6 Lock Washer - u



(4) M4 Spacer - v

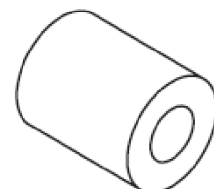

(4) M6 Spacer - w

## Installation

### Prepare Mounting Surface and Install Glides

1. Tape the paper template provided to the mounting surface in desired location.
2. Using a 1/4" Drill Bit, drill a hole at each marked location through template and mounting surface.
3. Orient left (k) and right (l) glides and place over holes in mounting surface. (See Figure 1)

**IMPORTANT !** : Make sure the end of the Glide with a Dowel is facing front.

4. Insert six button head cap screws (a) through glides, the mounting surface, and six washers(c). (See Figure 1)
5. Secure glides to mounting surface using six 1/4-20 Nuts (b). (See Figure 1)

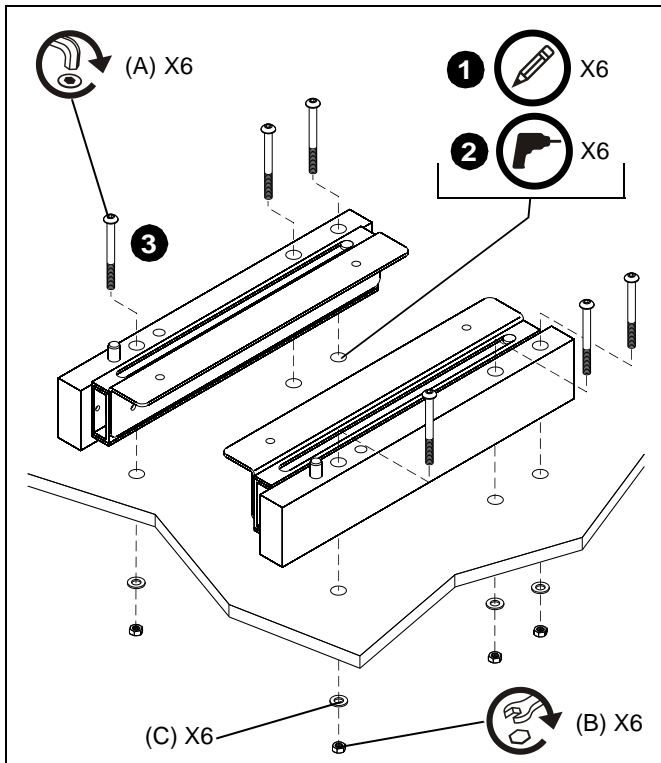

Figure 1

### Adjust Mount Outward Extension

The mount is designed with three maximum outward extension positions. The mount is shipped from the factory with the maximum outward extension set at pin position "A". (See Figure 2) and (See Figure 3). If outward extension is going to be changed it must be done before continuing mount installation.



**WARNING:** REMOVING STOP PINS WITHOUT PROPERLY ANCHORING THE MOUNTS SUPPORTING STRUCTURE CAN LEAD TO DISPLAY TIPPING CAUSING SERIOUS PERSONAL INJURY OR DAMAGE TO EQUIPMENT! The cabinet or armoire supporting the mount MUST be properly secured to a wall or similar structure capable of supporting the weight of the mount and all attached equipment in the fully extended position!

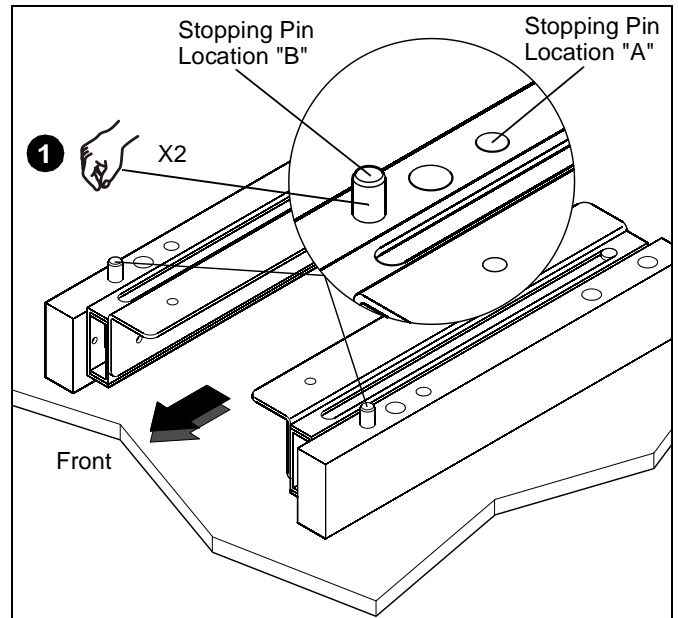

Figure 2

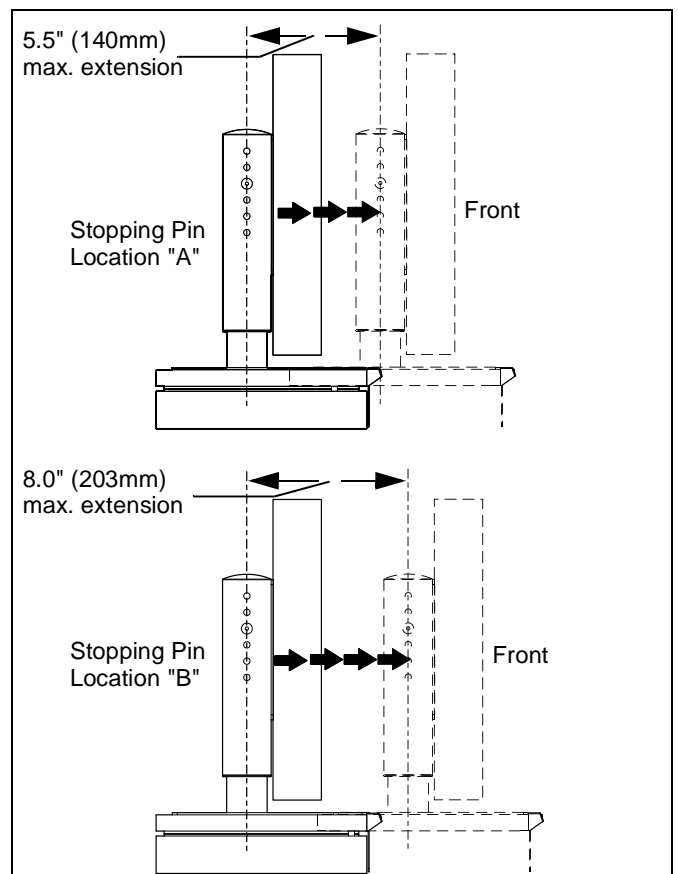

Figure 3

**Attach Top Assembly to Glides**

1. Orient base (j) so that four mounting holes face front and slotted side faces down. (See Figure 4)
2. Orient top assembly (m) so that vertical tube is closer to back. (See Figure 4)
3. Secure top assembly to base using four bolts (g) and hex wrench (i). (See Figure 4)

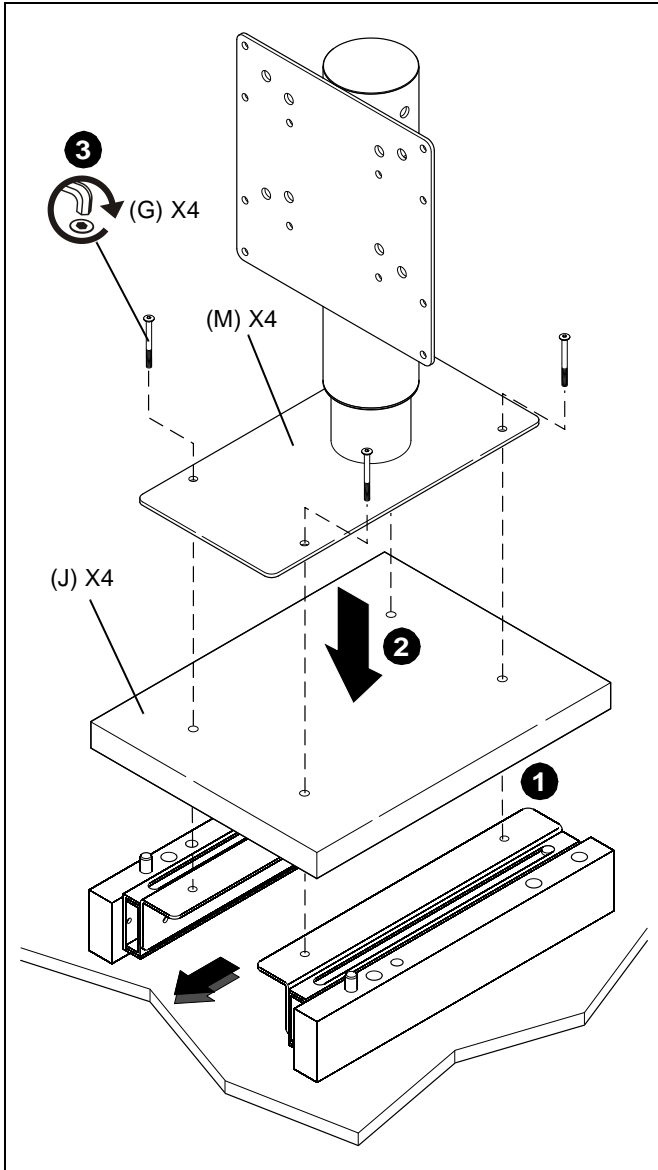

Figure 4

**Assemble Handle and Front Cover**

1. Align slots in handle (n) with four holes in front of base. (See Figure 5)
2. Align four mounting holes in front cover (o) with slots in handle (n) and four mounting holes in base.
3. Secure handle (n) and front cover (o) to base using four wood screws (h). (See Figure 5)

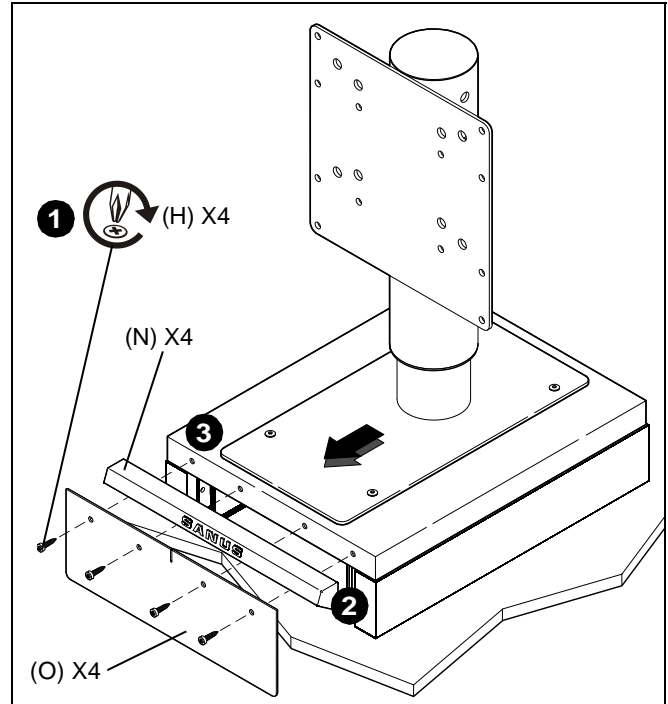

Figure 5

**Display Installation**

The MPO-V accommodates displays in sizes from 26" to 40". The mount face plate is designed to accommodate the mounting of displays that have a VESA compliant 100 x 100, 100 x 200, or 200 x 200 mounting pattern. (See Figure 6)

To install display:

1. Locate, measure and record the mounting pattern on the back of the display.

**IMPORTANT !:** If your display does not have one of the three VESA mounting patterns listed above, immediately contact a Chief Customer Service representative by calling 1-800-582-6480, or by visiting [www.chiefmfg.com](http://www.chiefmfg.com)

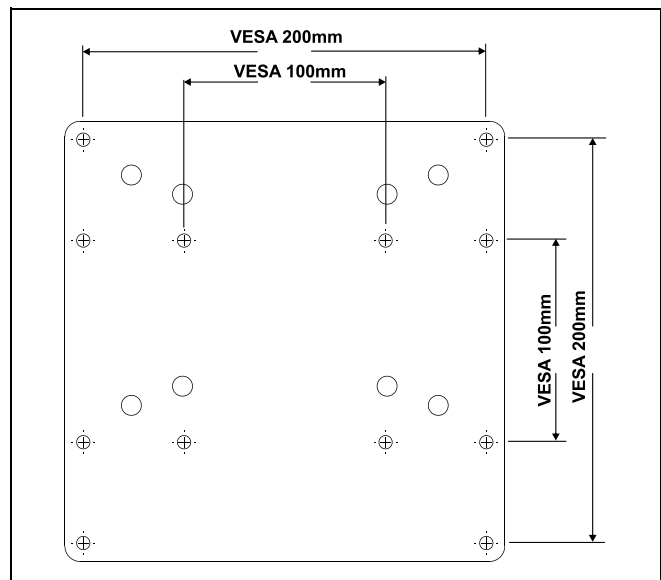

Figure 6

- Measure the distance from the approximate center of one of the lower mounting holes on display back to the lowest point on the display. (See Figure 7)

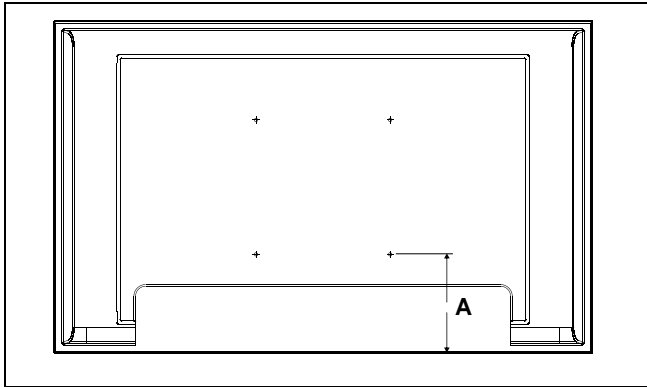

Figure 7

**IMPORTANT ! :**

- If the display has a VESA 200 x 200 mounting pattern and the dimension identified during step 2 is greater than 4 3/4" (121mm) or
- the display has a VESA 100 x 100 or 100 x 200 mounting pattern and the dimension identified during step 2 is greater than 6 3/4" (171mm) the faceplate will need to be adjusted upward before the display is mounted.

If not faceplate adjustment is required proceed to step 3 below.

To adjust faceplate:

- Loosen and remove faceplate positioning pin and nut using hex wrench provided with mount. (See Figure 8)
- Raise faceplate to desired height. (See Figure 8)

**NOTE:** Holes in column are spaced 1" (25mm).

**EXAMPLE:** If the display has a VESA compliant 200 x 200 mounting pattern and the dimension taken in step 2 above is 7 3/4", the faceplate positioning pin would need to be placed three holes ( or 3") below its factory position.

- Install positioning pin nut into appropriate hole in column.
- Install positioning pin through column and into positioning nut. (See Figure 8)
- Determine if the display has a flush or recessed mounting surface.

**NOTE:** In instances where there is an obstruction near the threaded insert in the back of the display, the use of a Spacer (v,w) and the longer screw (q,s) may be required.

- Determine size of hardware required by carefully threading screws into threaded inserts in display back. DO NOT continue if any resistance is encountered.
- Secure flush mount display to face plate using four washers (t) and four slotted pan head screws (p,q). (See Figure 9)
- Secure recessed mount display to face plate using four spacers (v,w), four washers (t,u), and four slotted pan head screws (r,s). (See Figure 9)

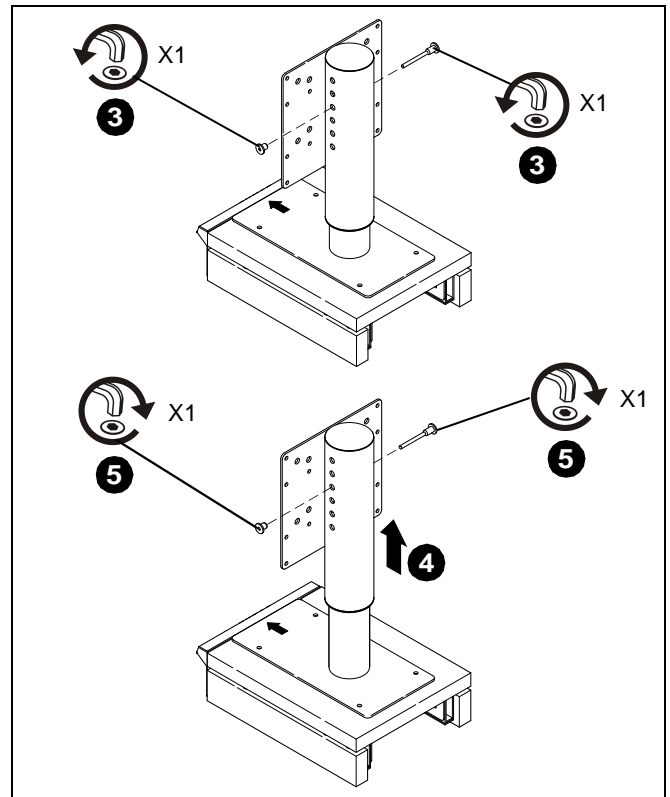

Figure 8

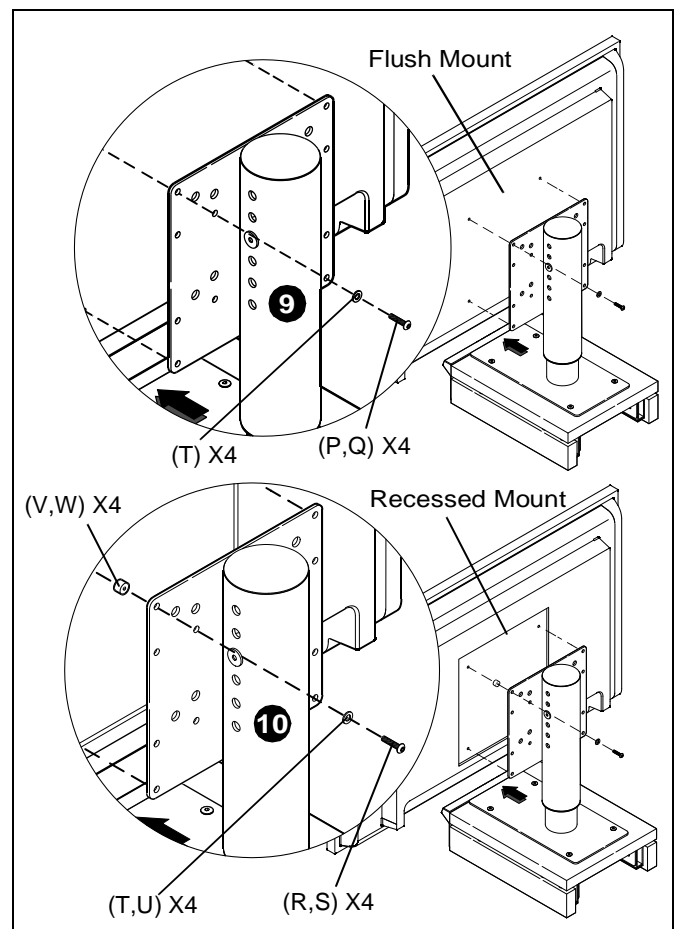

Figure 9



8804-000331 RevA  
©2007 Chief Manufacturing  
[www.chiefmfg.com](http://www.chiefmfg.com)  
06/07

<b>USA/International</b>	<b>A</b> 8401 Eagle Creek Parkway, Savage, MN 55378 <b>P</b> 800.582.6480 / 952.894.6280 <b>F</b> 877.894.6918 / 952.894.6918
<b>Europe</b>	<b>A</b> Fellenoord 130 5611 ZB EINDHOVEN, The Netherlands <b>P</b> +31 (0)40 2668620 <b>F</b> +31 (0)40 2668615
<b>Asia Pacific</b>	<b>A</b> Room 30I, Block D, Lily YinDu International Building LuoGang, BuJi Town, Shenzhen, CHINA. Post Code: 518112 深圳市布吉罗岗百合银都国际大厦D栋30I <b>P</b> +86-755-8996 9226 ; 8996 9236 ; 8996 9220 <b>F</b> +86-755-8996 9217