

INSTALLATION INSTRUCTIONS

Top Down Desk Mount Bracket Accessory Model: MSP-DARAC1B

Specifications:

- Designed for top-down installation of KCS-110 mount.
- Weight capacity of 40 lbs (18 kg).

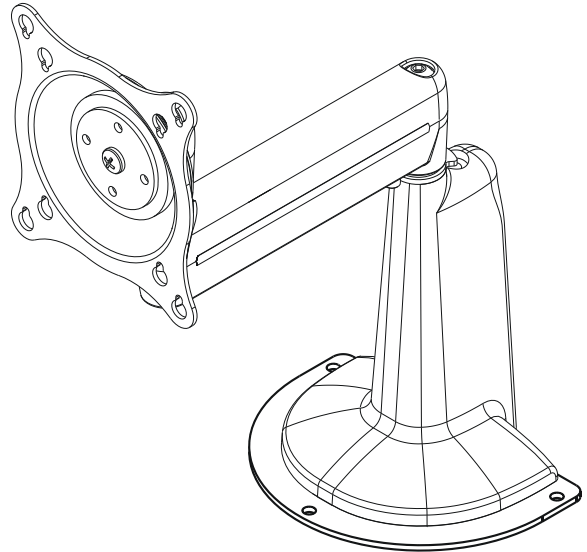

MSP-DARAC1B
(Shown installed on KCS-110, purchased separately)

BEFORE YOU BEGIN



WARNING: It is the installer's responsibility to make sure all components are properly assembled and installed using the instructions provided. Failure to read, thoroughly understand, and follow all instructions can result in serious personal injury, damage to equipment, or voiding of factory warranty.

- If you have any questions about these instructions or your specific installation, contact Chief Manufacturing at 1-800-582-6480 or 952-894-6280.

! IMPORTANT WARNINGS AND CAUTIONS!

WARNING: A WARNING alerts you to the possibility of serious injury or death if you do not follow the instructions.

CAUTION: A CAUTION alerts you to the possibility of damage or destruction of equipment if you do not follow the corresponding instructions.



WARNING: Failure to provide adequate structural strength for this component can result in serious personal injury or damage to equipment! It is the installer's responsibility to make sure the structure to which this component is attached can support five times the combined weight of all equipment. Reinforce the structure as required before installing the component.



WARNING: Exceeding the weight capacity can result in serious personal injury or damage to equipment! It is the installer's responsibility to make sure the combined weight of all components attached to the MSP-DARAC1B (including the mount and display) does not exceed 40 lbs (18 kg).



CAUTION: Overtightening fasteners may result in improper operation, excessive wear or damage to equipment, and/or voiding of factory warranty!

DIMENSIONS (AS INSTALLED ON KCS-110)

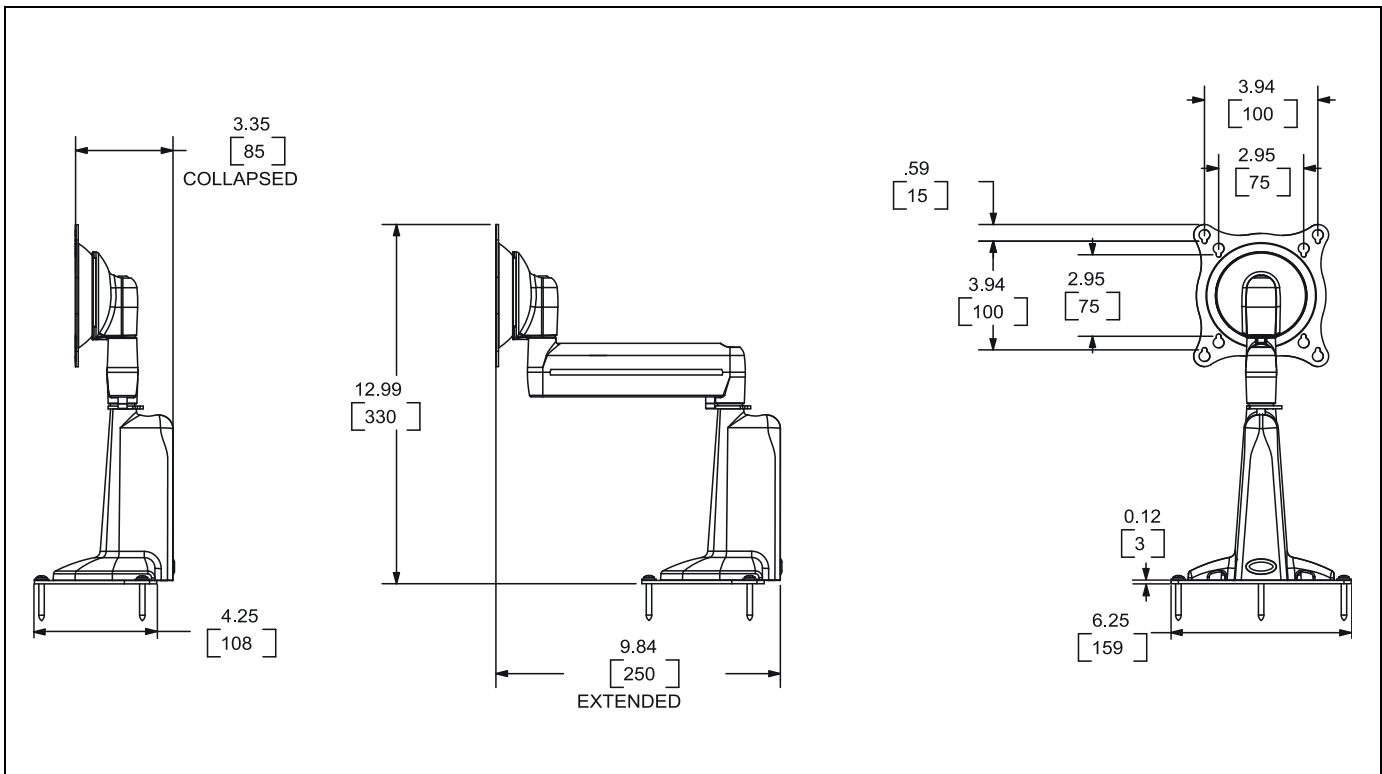

TOOLS REQUIRED FOR INSTALLATION

- Phillips Screwdriver, #1 and #2
- 2.5mm Hex Key (included with desk mount)

NOTE: Other tools may be required depending on your method of installation.

PARTS

After unpacking carton, inspect and verify contents (See Figure 1). If any listed parts are missing or damaged, contact Chief Customer Service at 1-800-582-6480.

Table 1: Parts

Item	Description	Qty
10	BRACKET, Top Down Desk Mount	1
20	SCREW, Phillips Pan Sheet Metal, #10 x 1-1/2"	3
30	WASHER, Flat, Machine, #10	3
40	SCREW, Phillips Flat Machine, M4 x 12mm	3
	MOUNT, Desk (required; not included)	1

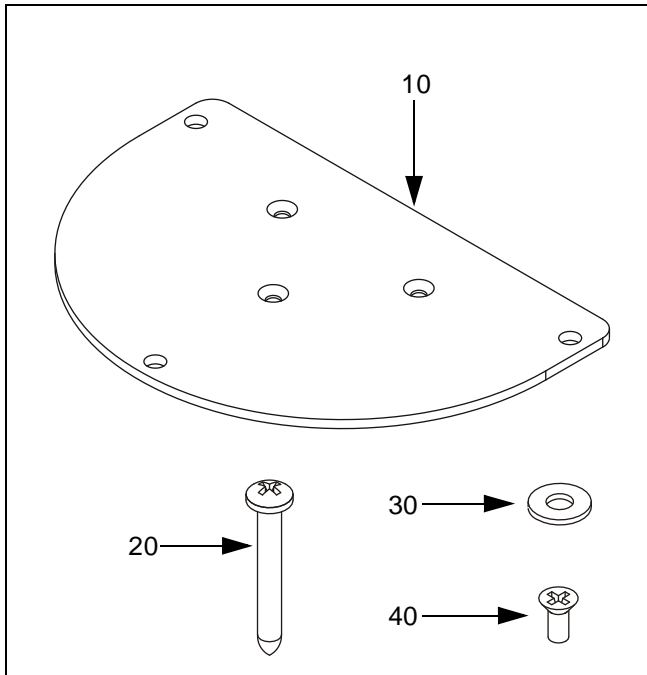

Figure 1: Parts

DESK MOUNT DISASSEMBLY

1. If previously attached, disconnect cables from display, then remove display. See instructions included with desk mount.
2. If previously attached, loosen clamp attach screw (See Figure 2). Remove desk mount from desk.

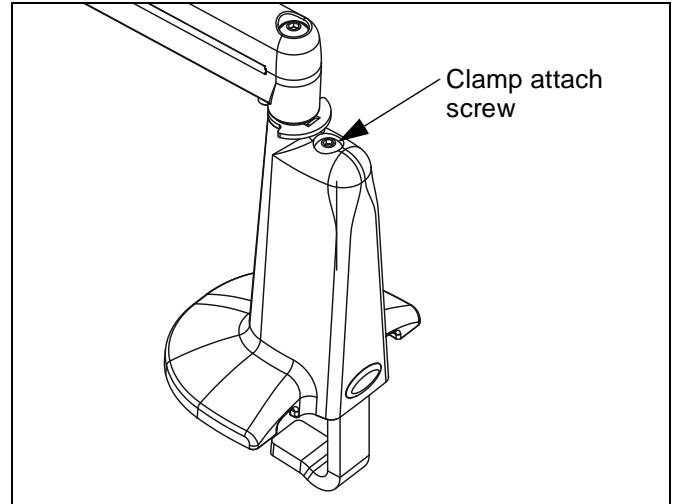

Figure 2: Remove Desk Mount

3. Using 2.5mm hex key, remove base plate and attach screws from desk mount housing (See Figure 3).

NOTE: Base plate and attach screws will not be reused in MSP-DARAC1B installation.

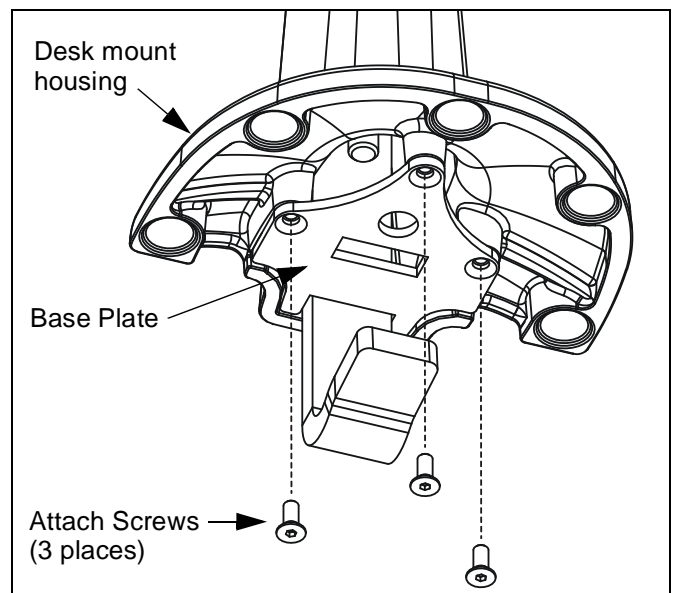

Figure 3: Remove Base Plate

4. Remove clamp attach screw, washer, and clamp from desk mount housing (See Figure 4).

NOTE: Clamp attach screw, washer, and clamp will not be reused in MSP-DARAC1B installation. However, if desired, attach screw can be inserted in bore for appearance only.

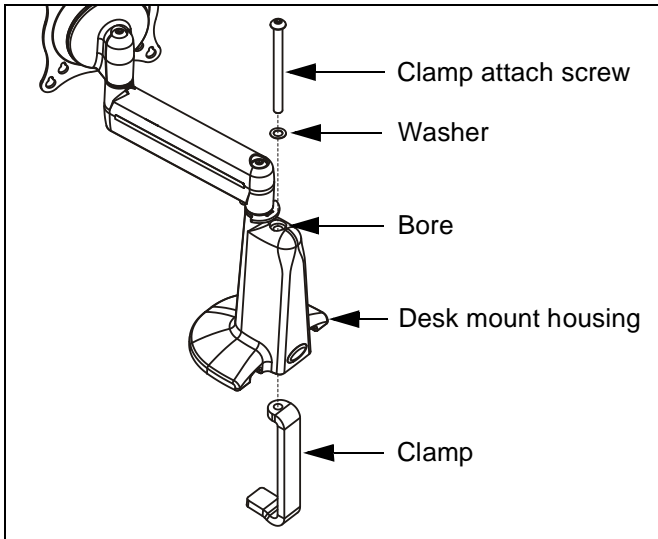

Figure 4: Remove Clamp

BRACKET INSTALLATION

1. Using Phillips screwdriver, install bracket (10) to desk mount housing with three screws (40) (See Figure 5). Tighten securely.

NOTE: If desired, adhesive pads can remain installed on bottom of desk mount housing.

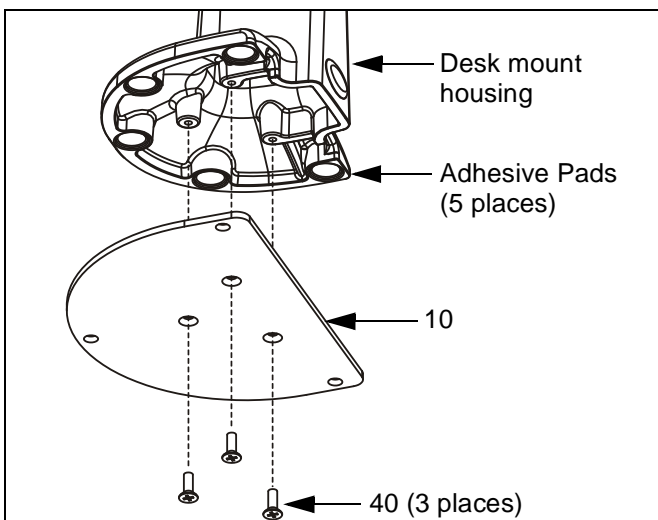

Figure 5: Install Bracket

MOUNT INSTALLATION

1. Determine approximate location for mount keeping in mind display size, arm extension, and pitch/roll requirements.
2. Using bracket (10) as a template, mark location of three pilot holes.
3. Drill three 1/8" diameter pilot holes in mounting structure at locations marked in previous step (See Figure 6). Ensure pilot holes are straight.

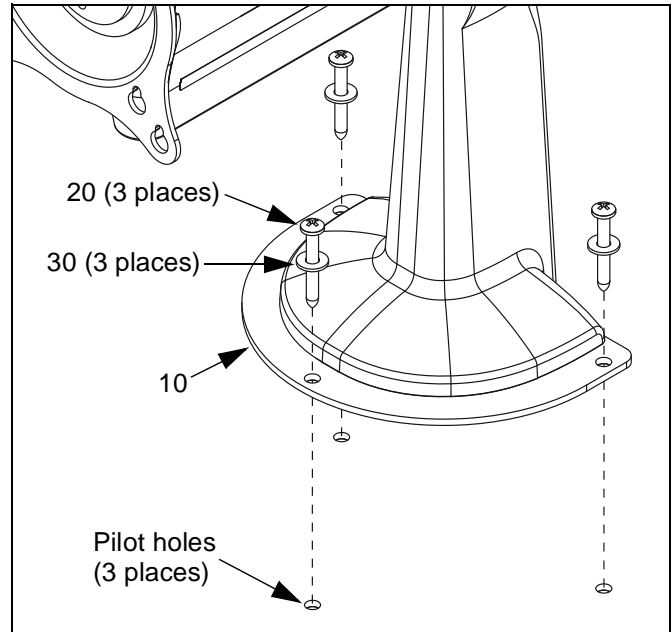

Figure 6: Install Mount

IMPORTANT ! : IF you will be installing a display with RECESSED mounting holes, then install display to mount *before continuing* with this mount installation procedure. Proceed to DISPLAY INSTALLATION section of Desk Mount Installation Instructions.

4. Using Phillips screwdriver, install screws (20) through washers (30) and mount (10) into pilot holes (See Figure 6). Tighten securely.
5. Refer to Desk Mount Installation Instructions for DISPLAY INSTALLATION (for display with *flush* mounting holes), CABLE MANAGEMENT, and ADJUSTMENT.