

REPLACEMENT INSTRUCTIONS

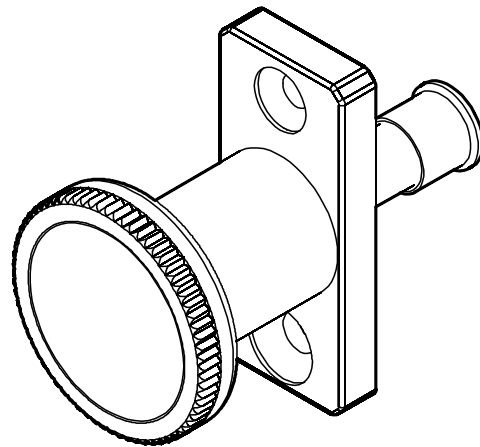

Carts and Stands Knob Replacement

DISCLAIMER

Milestone AV Technologies and its affiliated corporations and subsidiaries (collectively "Milestone"), intend to make this manual accurate and complete. However, Milestone makes no claim that the information contained herein covers all details, conditions or variations, nor does it provide for every possible contingency in connection with the installation or use of this product. The information contained in this document is subject to change without notice or obligation of any kind. Milestone makes no representation of warranty, expressed or implied, regarding the information contained herein. Milestone assumes no responsibility for accuracy, completeness or sufficiency of the information contained in this document.

Chief® is a registered trademark of Milestone AV Technologies. All rights reserved.



CAUTION: A CAUTION alerts you to the possibility of damage or destruction of equipment if you do not follow the corresponding instructions.



WARNING: Failure to read, thoroughly understand, and follow all instructions can result in serious personal injury, damage to equipment, or voiding of factory warranty! It is the installer's responsibility to make sure all components are properly assembled and installed using the instructions provided.



IMPORTANT WARNINGS AND CAUTIONS!



WARNING: A WARNING alerts you to the possibility of serious injury or death if you do not follow the instructions.

TOOLS / PARTS FOR INSTALLATION

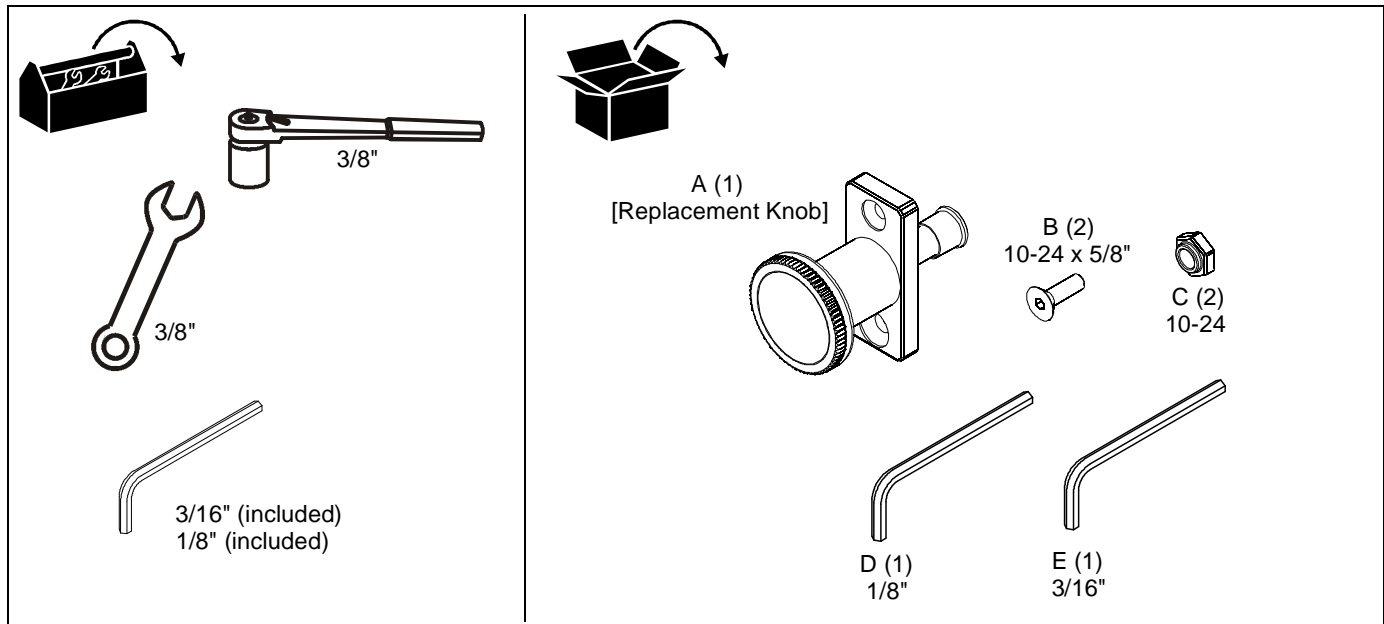

DISASSEMBLY

IMPORTANT ! : Disconnect and remove all cables.

Removing Display(s) from Cart or Stand

1. Remove bolt or padlock from faceplate (if used).

NOTE: The pin may have been used as a more permanent locking device. If so, remove nut and pin and move from the lower holes to the upper holes.

2. Pull back on flag on upper mounting hole and press pin down into "Open" position. (See Figure 1)



WARNING: EACH DISPLAY MAY WEIGH IN EXCESS OF 40 LBS! Always use two people and proper lifting techniques when installing or positioning display on cart or stand.

3. Carefully remove all display(s), equipment and shelves from cart or stand.
4. Lift up on pin and place flag back against faceplate to return it to "Closed" position.

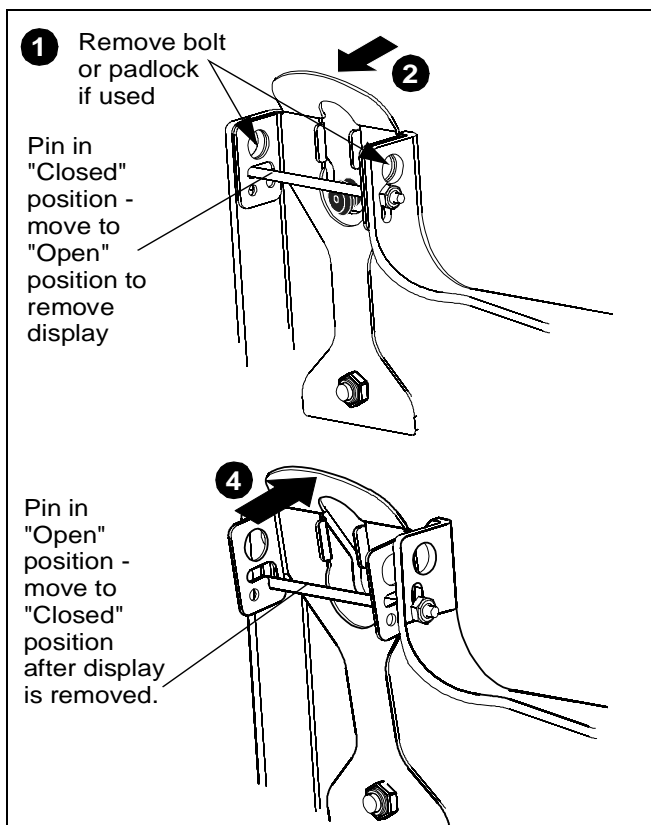

Figure 1

Removing Head Assembly

1. Remove and save four button head cap screws from head assembly. (See Figure 2)
2. Slide head assembly up and off the cart or stand column. (See Figure 2)

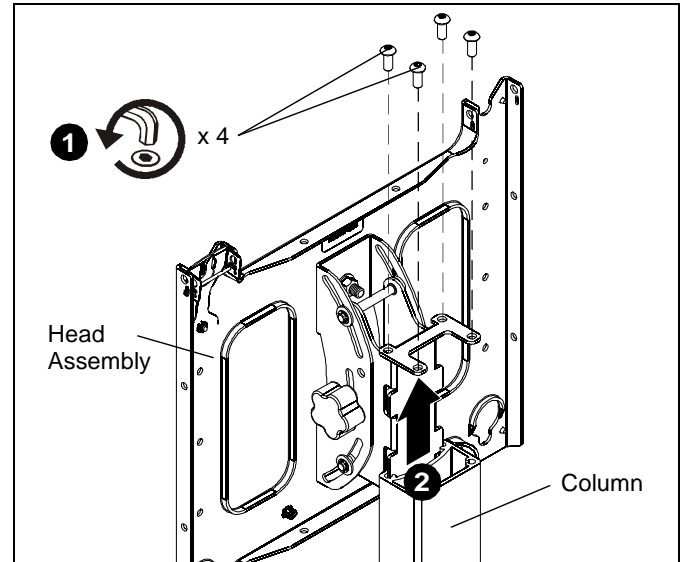

Figure 2

Removing Column from Cart or Stand

• Cart

1. Remove and save four button head cap screws and four washers from cart legs. (See Figure 3)
2. Proceed to **Removing Inner Column** section.

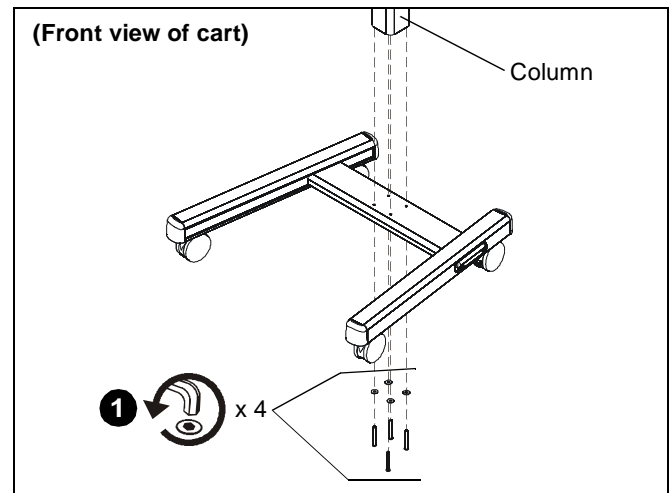

Figure 3

• Stand

1. Remove and save four button head cap screws and four flat washers from top base section and column. (See Figure 4)
2. Proceed to **Removing Inner Column** section.

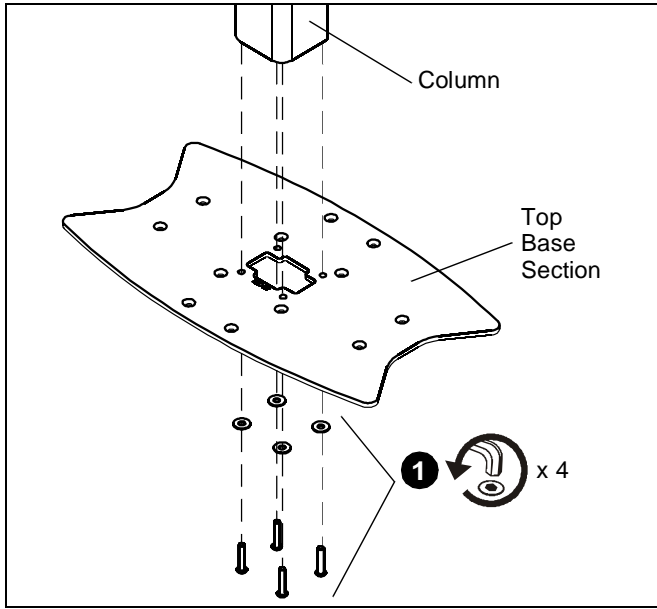

Figure 4

Removing Inner Column

1. Lift up on the inner column of center post. (See Figure 5)
2. Pull out knob on the center post and turn 90° in either direction to disengage the locking mechanism. (See Figure 5)

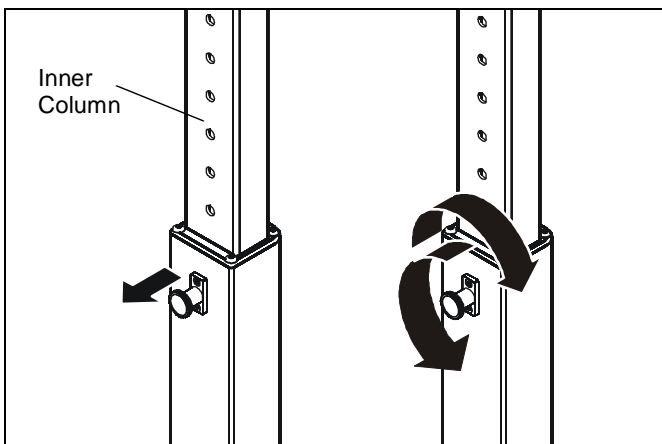

Figure 5

3. Completely remove inner column from center post by sliding it out the bottom end of the center post.

ASSEMBLY

Removing / Installing Knob Assembly

1. Remove two locking nuts and flat head cap screws from current knob assembly, and remove knob assembly from center post.
2. Insert new knob assembly (A) into center post. (See Figure 6)

3. Fasten new knob assembly using two 10-24 x 5/8" flat head cap screws (B) and two 10-24 lock nuts (C). (See Figure 6)

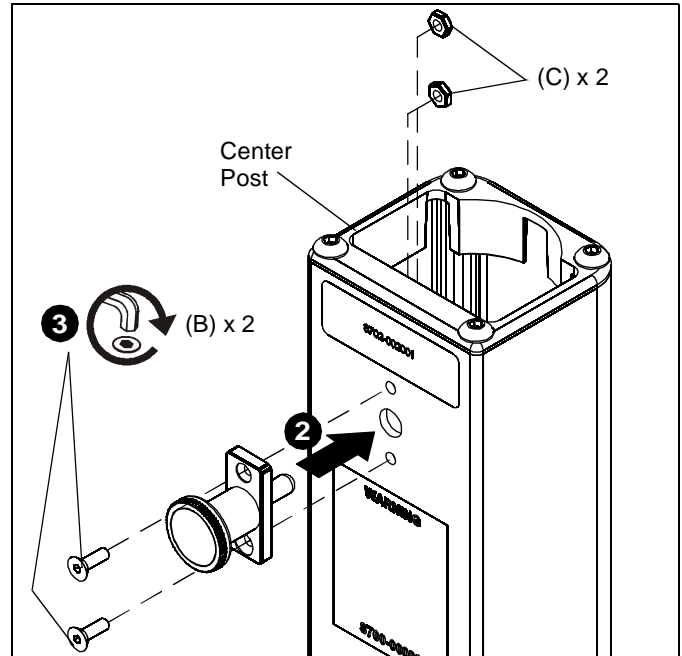

Figure 6

Inserting Inner Column

1. Retract the knob to allow the inner column to slide into place in the center post.
2. Re-install the inner column into the center post by sliding the inner column up from the bottom of the center post. (See Figure 7)

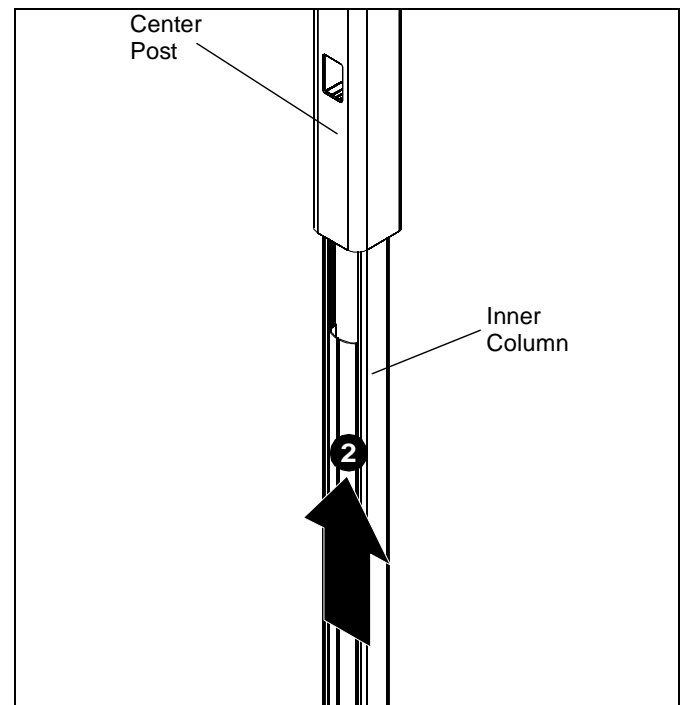

Figure 7

Assembling Base to Stand

IMPORTANT ! : Disengage knob on center post **BEFORE** attaching base to center post.

1. Lift up on the inner column of center post. (See Figure 8)
2. Pull out knob on the center post and turn 90° in either direction to disengage the locking mechanism. (See Figure 8)
3. Raise the inner column and turn the knob 90° in either direction to engage the knob and lock the column in place. (See Figure 8)

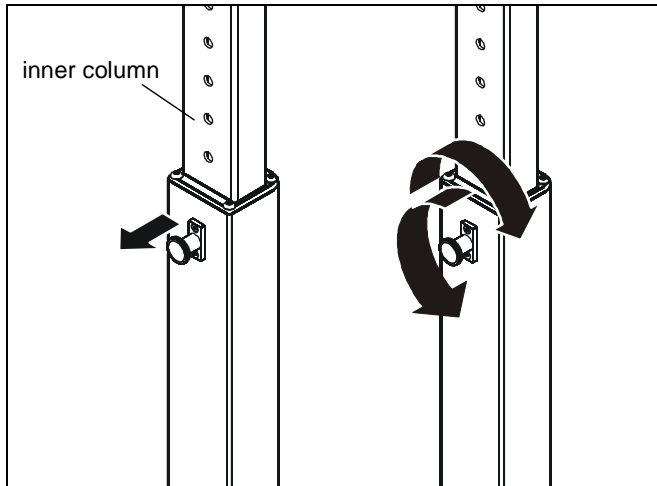

Figure 8

4. Attach base section to the center post using four 16-18 x 1-1/2" button head cap screws and four 5/16" flat washers removed in removed in Step 1 of **Removing Column from Cart or Stand** section. (See Figure 9)

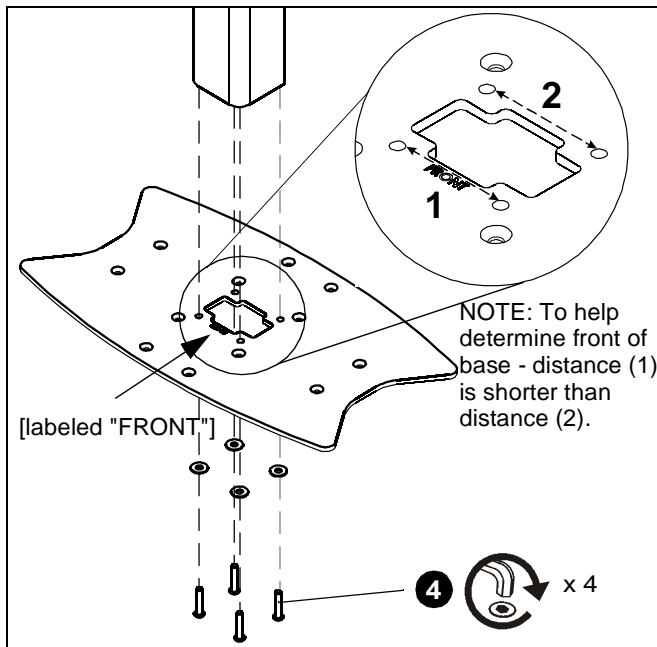

Figure 9

NOTE: Ensure that center post front is placed to the front of base section. Check for "FRONT" on base section. (See Figure 9)

NOTE: Insert and tighten screws in order shown (1, 2, 3, 4). (See Figure 10)

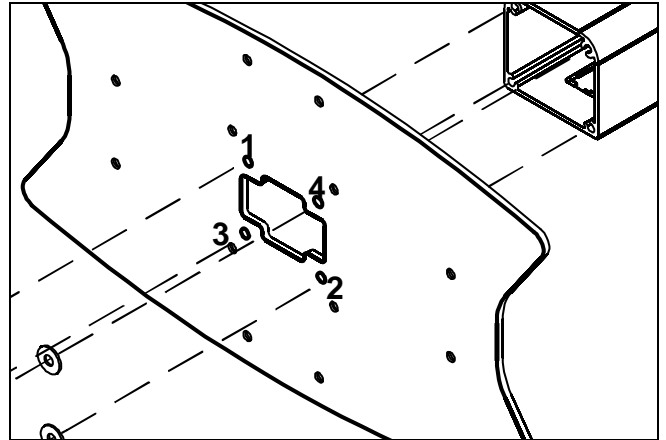

Figure 10

Assembling Cart Center Post to Legs

1. Attach center post to leg assembly using four button head cap screws and four 5/16" flat washers removed in Step 1 of **Removing Column from Cart or Stand** section. (See Figure 11)

NOTE: Insert and turn screws in order shown (1, 2, 3, 4). (See Figure 11)

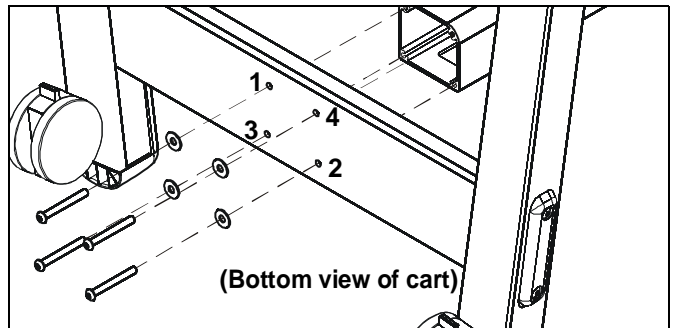

Figure 11

Replacing Head Assembly

IMPORTANT ! : When attaching head assembly ensure that the ClickConnect lock is at TOP of head assembly, and bracket tabs slide into the stand assembly. (See Figure 12)

1. Slide head assembly into the stand assembly. (See Figure 12)
2. Attach head assembly to stand using four button head cap screws removed in **Removing Head Assembly** section. (See Figure 12)

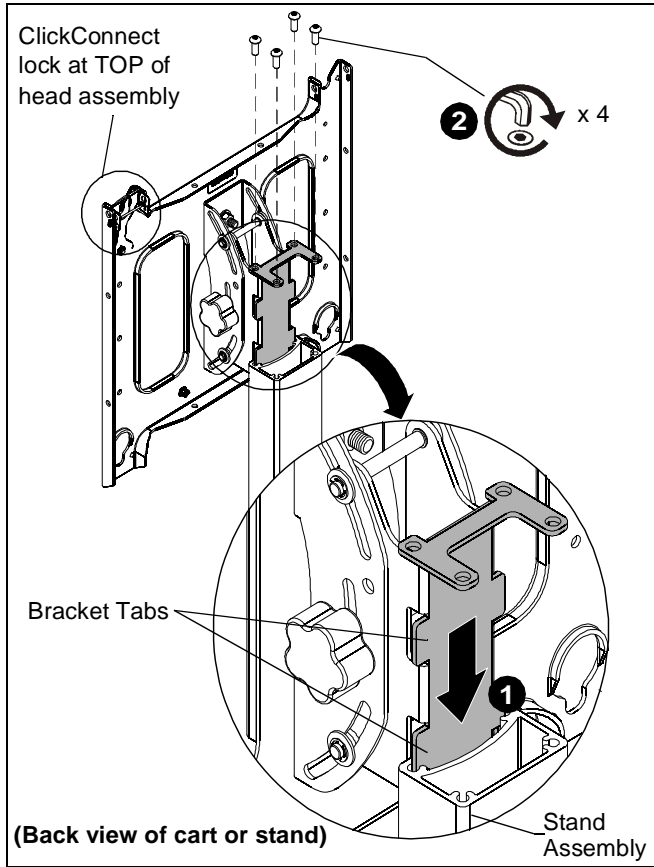

Figure 12

Reattaching Display

WARNING: EXCEEDING MAXIMUM WEIGHT CAPACITY MAY LEAD TO SERIOUS PERSONAL INJURY OR DAMAGE TO EQUIPMENT! It is the installer's responsibility to ensure the total amount of weight placed on the cart or stand does not exceed 125 lbs (56.70 kg) for the MFC, 200 lbs (90.72 kg) for the PFC, 125 lbs (56.70 kg) for the MF1, 250 lbs (113.40 kg) for the MF2 [125 lbs (56.70 kg) per faceplate]; 200 lbs (90.72 kg) for the PF1, 400 lbs (181.44 kg) for the PF2 [200 lbs (90.72 kg) per faceplate].

CAUTION: Before attaching display to cart set the brakes on the back wheels by pressing down on the tab. (See Figure 13)

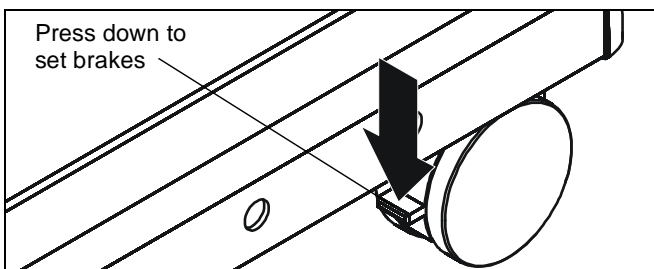

Figure 13

1. Adjust the cart or stand to the desired height by slightly lifting the inner column, pulling out knob on the center post and turning 90° in either direction to disengage the locking mechanism. (See Figure 14)
2. Raise or lower the center post, then turn the knob 90° either direction to engage the knob and lock the cart at desired height. (See Figure 14)

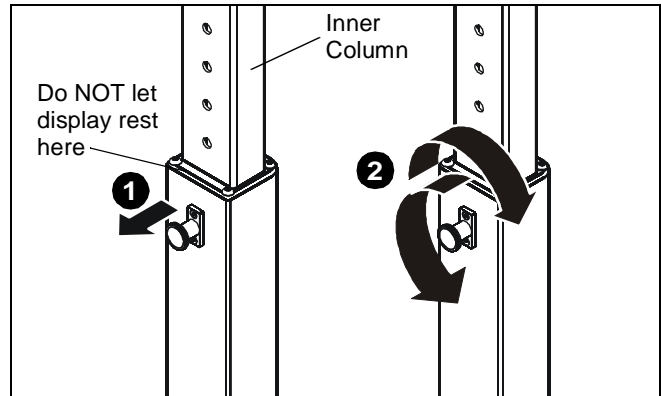

Figure 14

IMPORTANT ! : Set the height of the cart or stand so the display does NOT rest on the lower part of the center post. (See Figure 14) Always set the height so the knob is engaged in a hole in the center post.

3. Attach a PSBU or MSBU interface bracket to the display following the instructions included with the bracket.
4. While supporting both sides of display, align four mounting buttons on display or interface bracket with four mounting holes in head assembly. (See Figure 15) and (See Figure 16)

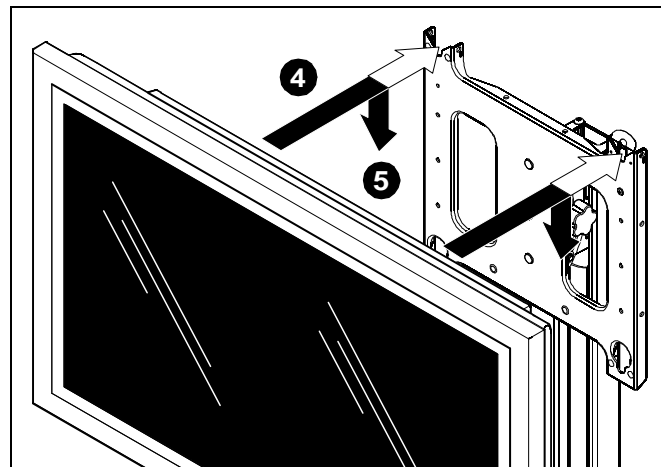

Figure 15

WARNING: DISPLAY MAY WEIGH IN EXCESS OF 40 LBS! Always use two people and proper lifting techniques when installing or positioning display on cart or stand.

5. Lower display into place listening for audible "click" to ensure recessed area of mounting buttons are properly seated in lower area of mounting holes. (See Figure 15) and (See Figure 16)



WARNING: IMPROPER INSTALLATION CAN LEAD TO CART, STAND OR DISPLAY FALLING CAUSING SERIOUS PERSONAL INJURY OR DAMAGE TO EQUIPMENT!

Ensure mounting buttons are completely engaged in mounting holes.

- NOTE:** Holes are provided in the faceplate for use with a padlock or similar locking device, if desired. In addition, the pin and nut may be removed from the upper holes and moved to the lower holes for use as a more permanent locking device. (See Figure 16)

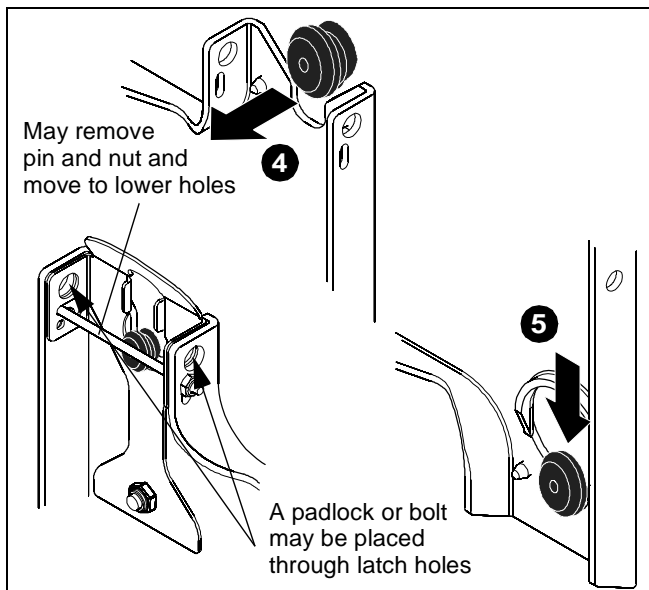

Figure 16

6. If applicable, reinstall all shelves, equipment, cables and wires which were removed earlier.
7. Reinstall any padlocks or locking bolts which were removed earlier.



Our Mounts. **Your Vision.**

Chief Manufacturing, a products division
of Milestone AV Technologies

8807-002014 Rev00
©2009 Milestone AV Technologies, a
Duchossois Group Company
www.chiefmfg.com
08/09

USA/International A 8401 Eagle Creek Parkway, Savage, MN 55378
P 800.582.6480 / 952.894.6280
F 877.894.6918 / 952.894.6918

Europe A Fellenoord 130 5611 ZB EINDHOVEN, The Netherlands
P +31 (0)40 2668620
F +31 (0)40 2668615

Asia Pacific A Room 24F, Block D, Lily YinDu International Building
LuoGang, BuJi Town, Shenzhen, CHINA.
深圳市布吉罗岗村百合银都国际大厦D栋24F
P +86-755-8996 9226
F +86-755-8996 9217

