

INSTALLATION INSTRUCTIONS

Touch Screen Stand

Model: MSP-WRTS1

The WRTS1 is a free standing solution for point of purchase displays.

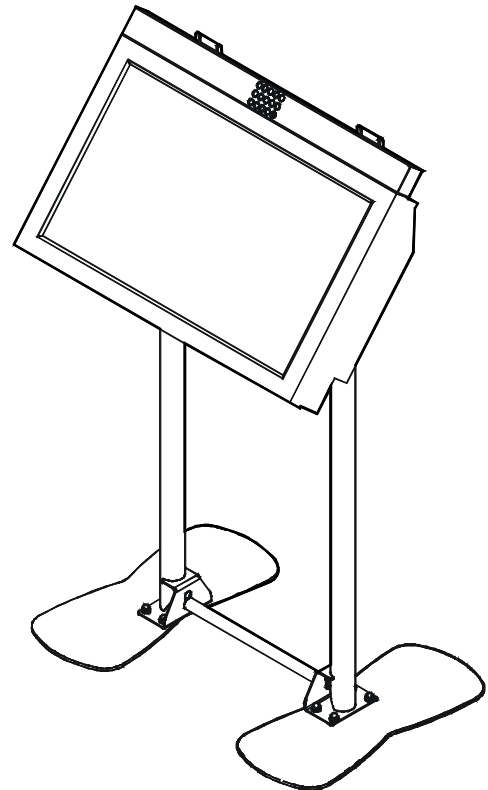

BEFORE YOU BEGIN



CAUTION: To prevent damage to the Kit, which could affect or void the Factory warranty, and to the equipment that will be attached to it, thoroughly study all instructions and illustrations before you begin the installation.

- If you have any questions about this installation, contact Chief Manufacturing at 1-800-582-6480.



IMPORTANT WARNINGS AND CAUTIONS!

WARNING: A WARNING alerts you to the possibility of serious injury or death if you do not follow the instructions.

CAUTION: A CAUTION alerts you to the possibility of damage or destruction of equipment if you do not follow the corresponding instructions.



WARNING: It is the installer's responsibility to make sure the structure to which this unit is attached can support five times the combined weight of all equipment. Reinforce the structure as required before installing the unit. Failure to provide adequate structural strength for this unit can result in serious personal injury or damage to equipment!



WARNING: It is the installer's responsibility to make sure the combined weight of the display, mount, accessories, and any other attached equipment must not exceed 75lbs (34kg), the maximum support weight of this unit. Exceeding the maximum support weight can result in serious personal injury or damage to equipment!



WARNING: Make sure the latches securing the display are fully closed at all times except when removing or installing the display. The latches must be fully closed when installing or removing cables from the display.



WARNING: Watch for pinch points. Do not put your fingers between movable parts.

TOOLS REQUIRED FOR INSTALLATION

- 9/16" Wrench
- 7/32" Hex Key (provided)
- Phillips Screwdriver

PARTS

Unpack carton, inspect and verify contents. Read installation instructions completely. If any listed parts are missing, contact Chief Customer Service at 1-800-582-6480.

PARTS (continued)

Table 1: Parts

Item	Description	Qty	Item	Description	Qty
10	HOLDER ASSEMBLY, CPU	1	140	WASHER, Lock, 3/8"	14
20	CLIP, Cable Management (pre-installed)	2	150	SCREW, Flat Head Cap, 3/8-16 x 3/4	8
30	BASE, Stand	2	160	Capplug	2
40	BRACKET ASSEMBLY, Speaker, Right	1	170	WASHER, Flat, 3/8"	4
50	FACEPLATE	1	180	TIE, Cable, Black, 5 3/4" Long (included but not shown)	5
60	THUMBNUIT, Knurled	4	190	WASHER, Flat, 1/4"	4
70	COVER, CPU	1	200	SCREW, Phillips Pan Head Machine, 1/4-20 x 1/2"	8
80	BRACKET ASSEMBLY, Speaker, L.H.	1	*210	PAD, Felt (included but Not shown)	4
90	COVER, LCD	1	*220	RETAINER, Screen (included but Not shown)	1
100	UPRIGHT, Stand	2	*230	BUTTON, Screen Mounting (included but Not shown)	4
110	SUPPORT, Upright Cross	1	*240	SCREW, Phillips Pan Head, M4 x 30mm (included but Not shown)	2
120	SCREW, Hex Head Cap, 3/8-16 x 3/4"	6	*250	WASHER, Flat, M4 (included but Not shown)	2
130	NUT, Acorn, 3/8-16	8	*260	SCREW, Phillips Pan Head, 8-32 x 5/8" (included but Not shown)	4
			*270	WASHER, Flat, #8 (included but Not shown)	4

* indicates hardware used for mounting od display to the MSP-WRTS1.

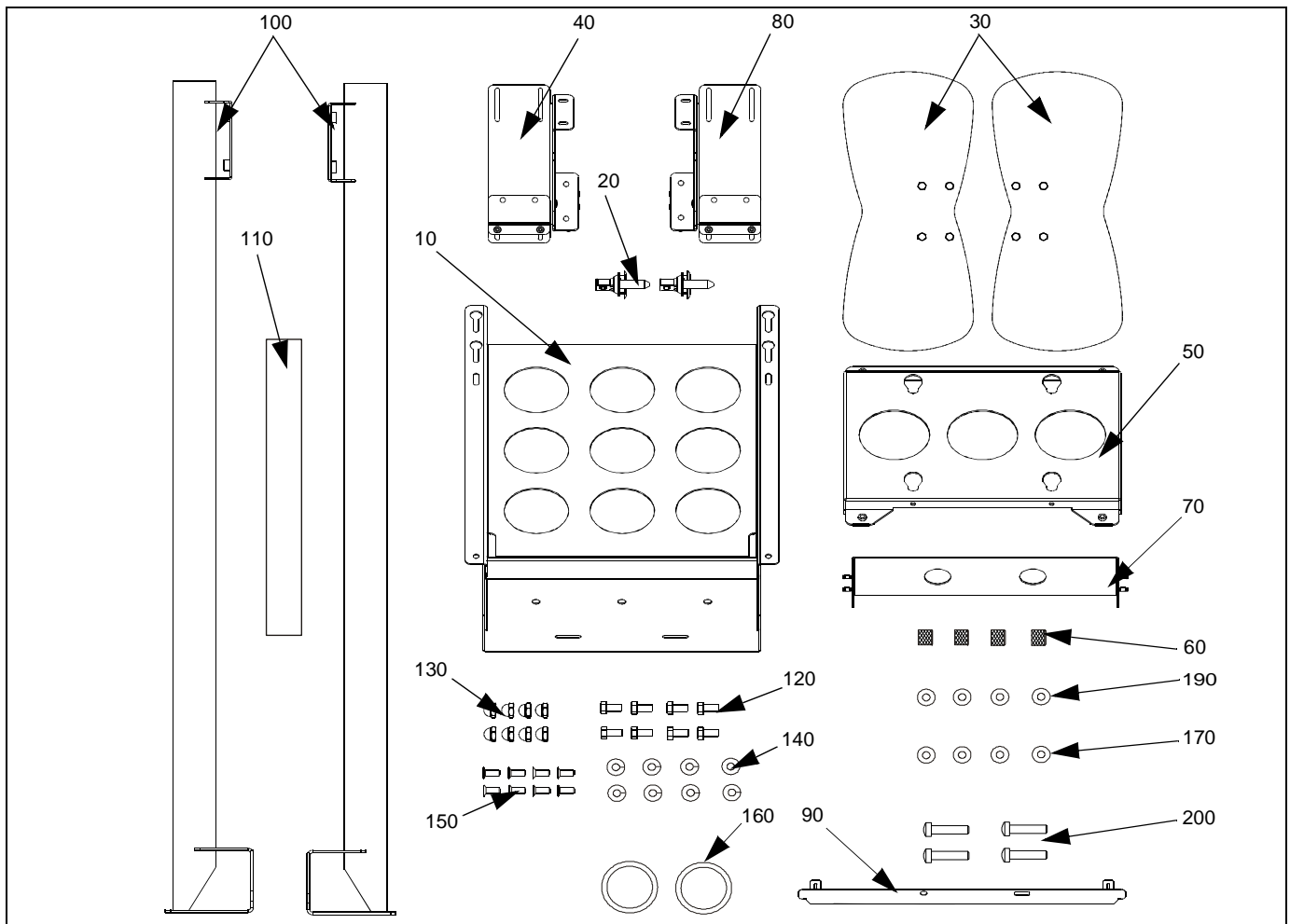

Figure 1: PARTS

ASSEMBLY AND INSTALLATION

Assemble Stand Base

1. Align mounting holes in R.H. upright (100) with mounting holes in R.H. base (30). (see Figure 2)
2. Insert four FHCS (150) through mounting holes in bottom of R.H. stand base (30) and through mounting holes in R.H. upright (100).
3. Secure R.H. upright (100) to R.H. stand base (30) using four LW (140) and four acorn nuts (130).
4. Align mounting holes in L.H. upright (100) with mounting holes in L.H. base (30).
5. Insert four FLCS (150) through mounting holes in bottom of L.H. stand base (30) and through mounting holes in L.H. upright (100).
6. Secure L.H. upright (100) to L.H. stand base (30) using four LW (140) and four acorn nuts (130).

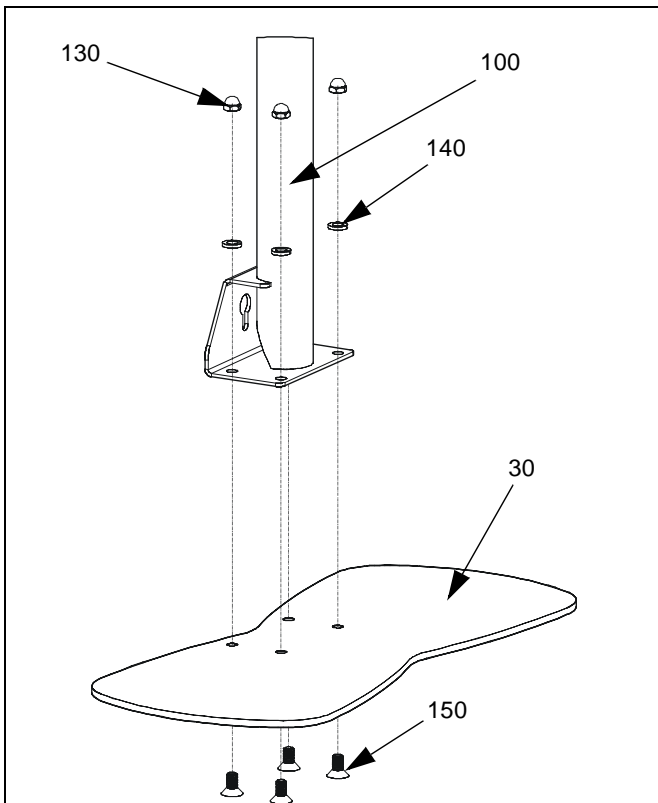

Figure 2: Assemble Uprights to Base

7. Align tapped hole in end of support bar (110) with teardrop hole in lower R.H. upright (100).
8. Secure support bar (110) to R.H. upright (100) using one LW (140) and one HHCS (120). (see Figure 3)

NOTE: DO NOT tighten hardware at this time.

9. Align tapped hole in end of support bar (110) with teardrop hole in lower L.H. upright (100). Once HHCS has been started, seat cross support bar (110) into bottom of teardrop slot.

10. Secure support (110) bar to L.H. upright (100) using one LW (140) and one HHCS (120). (see Figure 3)
11. DO NOT tighten hardware at this time.

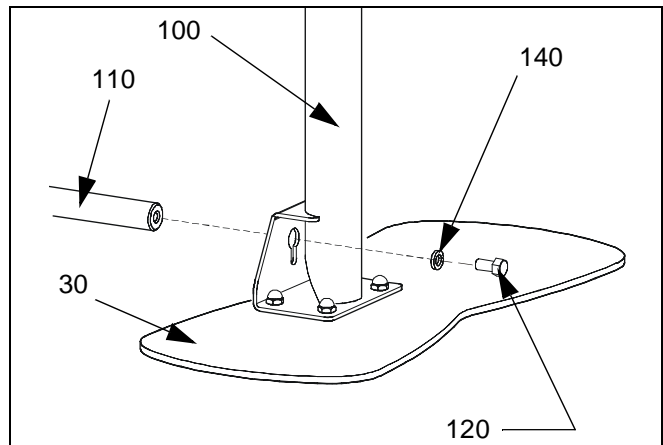

Figure 3: Assemble Support Bar To Base

Assemble Faceplate To Stand Base

1. Align mounting holes in faceplate (50) with mounting holes on R.H. upright (100). (see Figure 4)
2. Secure faceplate (50) to R.H. upright (100) using two FL (170), two LW (140), and two HHCS (120).
3. Repeat steps 1 and 2 for L.H. side.
4. Tighten hardware securing faceplate (50) to uprights (100). (see Figure 4)

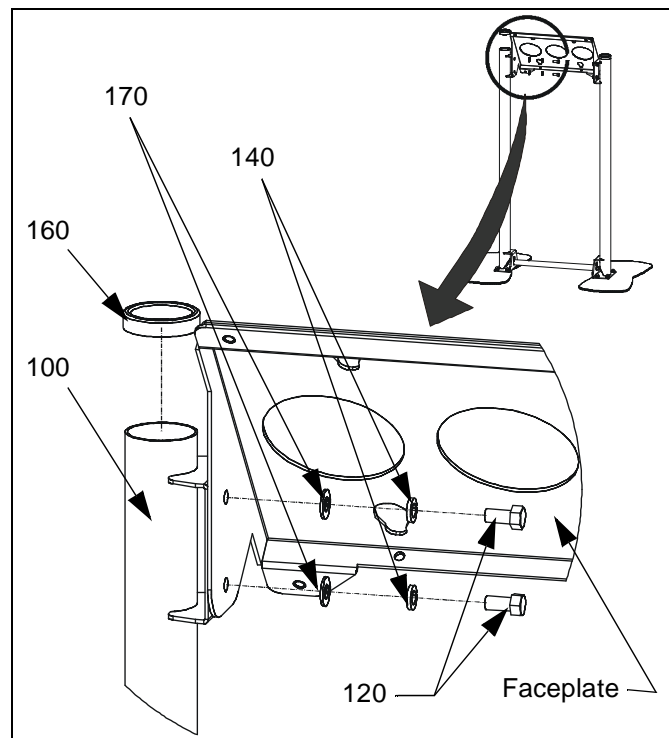

Figure 4: Assemble Faceplate to Stand Base

Assemble CPU Holder to Faceplate

1. Align mounting holes in CPU holder assembly (10) with mounting holes in faceplate (50). (see Figure 5)
2. Secure CPU holder assembly (10) to faceplate (50) using four FW (190), and four PPMS (200).

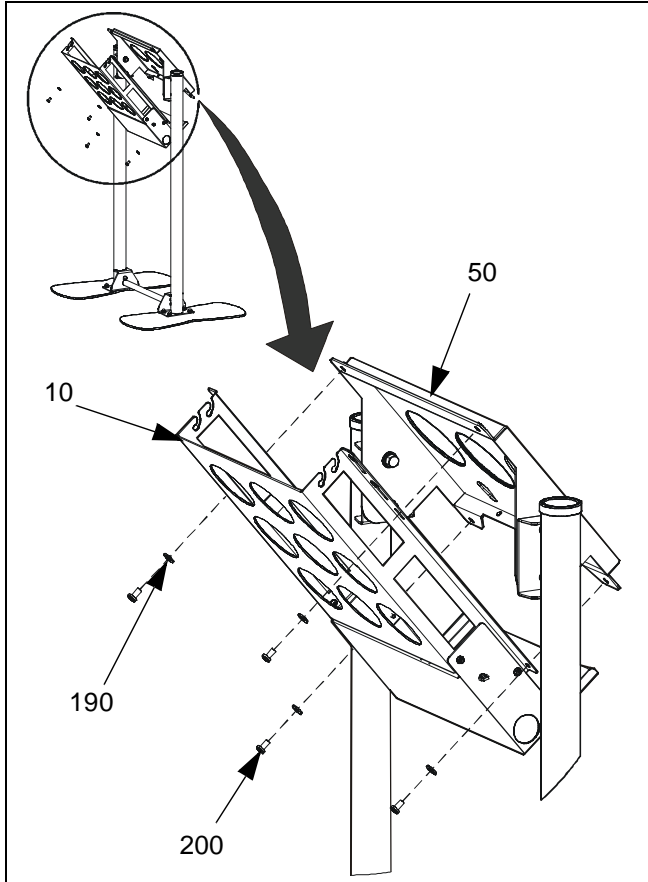

Figure 5: Assemble CPU Holder to Faceplate

Install Speaker Brackets

1. Install speaker bracket assemblies (40 and 300) to CPU Holder assembly (10) using four PPMS (200). (see Figure 6)

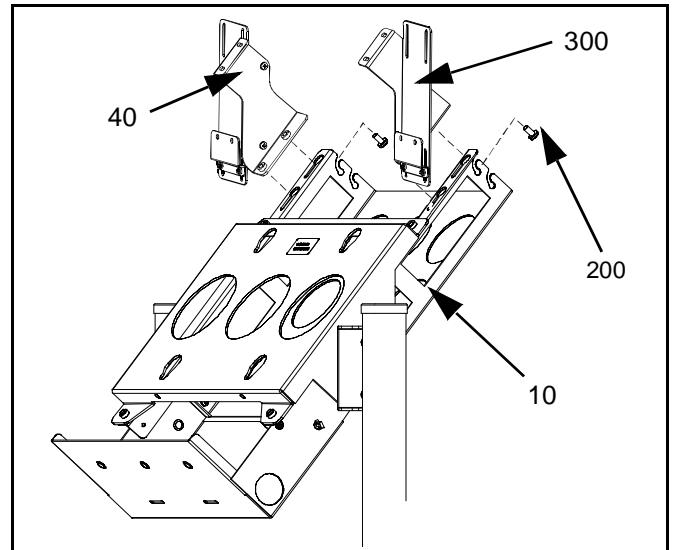

Figure 6: Install Speaker Brackets

Assemble CPU Holder Top Cover to CPU Holder

1. Place threaded stud on CPU cover (70) into slots in CPU holder assembly (10). (see Figure 7)
2. Secure CPU cover (70) to CPU holder assembly (10) using four thumb nuts (60).

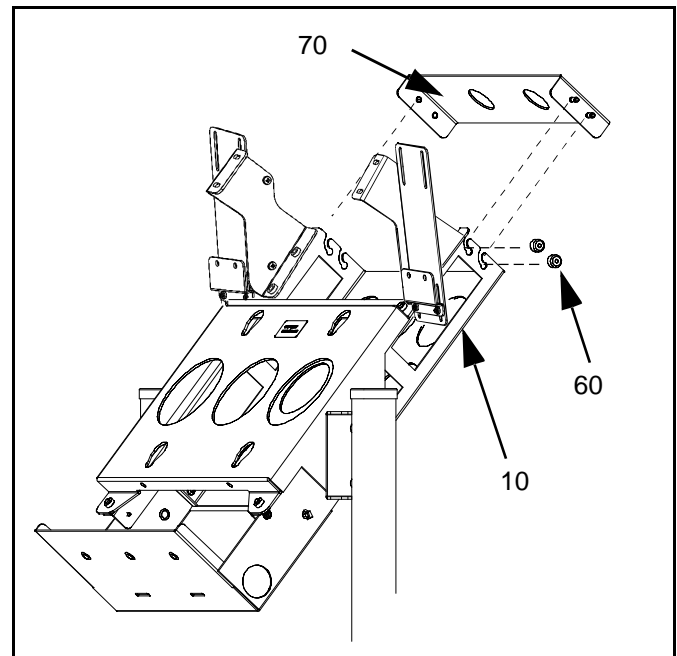

Figure 7: Assemble CPU Holder Top Cover

