



INSTALLATION INSTRUCTIONS

OFB-105 AND OFB-165 PANEL-TO-PANEL MOUNT ADAPTER BRACKET

Prior to assembly, unpack carton completely and verify contents.

If you are missing any of the following components, please contact Customer Service at 1-800/582-6480

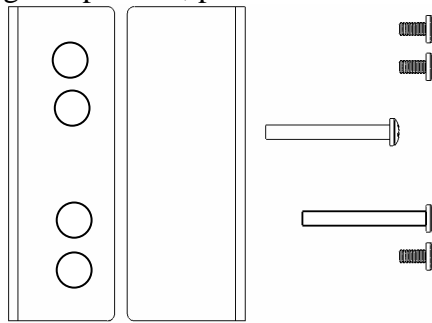

Figure 1

- (1) Adapter Bracket, Right
- (1) Adapter Bracket, Left
- (1) Screw, Pan Head, Nylon, Long (Except OFB-165)
- (3) Screw, Pan Head, 10-24, Short
- (1) Screw, Pan Head, 10-24, Long

BEFORE PROCEEDING, READ INSTALLATION INSTRUCTIONS COMPLETELY

NOTE: Suggested tools include a magnetic screwdriver and a small hammer.

NOTE: Inserting adapter bracket into slots may require tapping it into place with a small hammer.

1. Insert the right adapter bracket; tabs facing up, into the office furniture equipment mounting slots at desired height (see Figure 2).
2. Insert the left adapter bracket, tabs facing down, into slots of office furniture equipment and slide the adapter bracket down until mounting holes align (see Figure 2).

NOTE: Holes in the mounting bracket supplied with your mounting assembly should align with the threaded holes in the installed adapter brackets. If holes do not align, adapter brackets are not seated and must be tapped further into place.

3. Secure the mounting bracket (supplied with your mounting assembly) by installing three short 10-24 pan head screws (see Figure 3 and Figure 4).

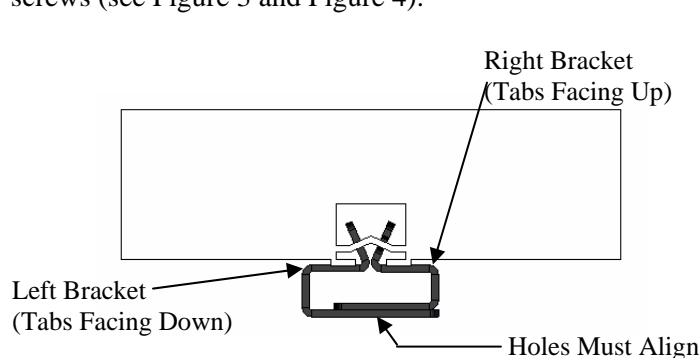

Figure 2

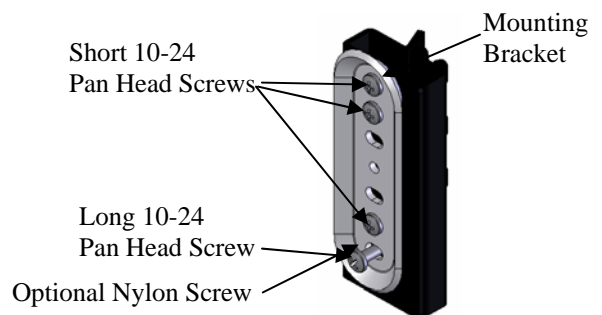

Figure 3

4. Secure the mounting bracket to the mounting furniture using the longer 10-24 pan head screw (see Figure 3 and Figure 4).
5. Replace long 10-24 pan head screw with Nylon screw (provided) to prevent furniture paint damage if necessary, being careful not to over tighten Nylon screw.
6. Install your mount as described in the directions accompanying your mount.

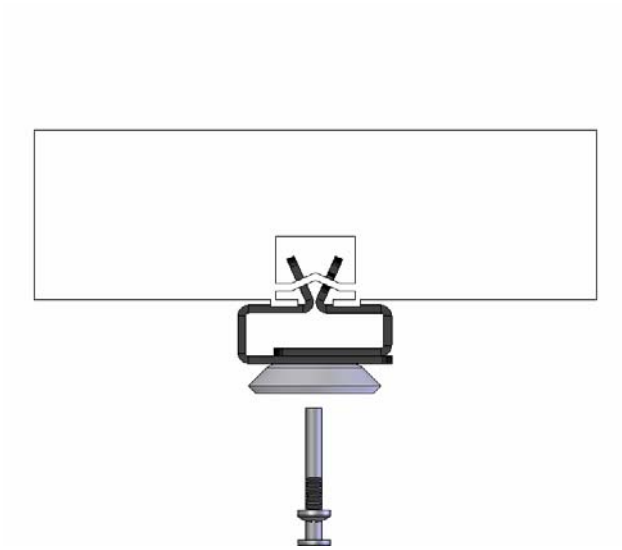

Figure 4