



INSTALLATION INSTRUCTIONS

OFB-146 and OFB-148

WALL TRACK ADAPTER BRACKET

Prior to assembly, unpack carton completely and verify contents.

If you are missing any of the following components, please contact Customer Service at 1-800/582-6480

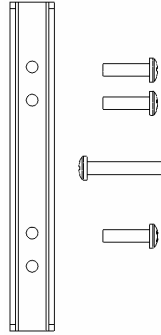

(1) Adapter Bracket

Figure 1

(3) Screw, Pan Head, 10-24
(1) Screw, Nylon

BEFORE PROCEEDING, READ INSTALLATION INSTRUCTIONS COMPLETELY

NOTE: Suggest using a magnetic screwdriver.

1. Secure the adapter bracket to the mounting bracket (supplied with your mounting assembly) by loosely installing four 10-24 pan head screws.
2. Slide the adapter bracket, with the mounting bracket, down the track of the office furniture slot (see Figure 2).
3. Tighten the three 10-24 pan head screws to secure adapter bracket at desired height, making sure screws fit into slots of office furniture (see Figure 3).
4. Install Nylon screw (provided) in remaining hole for additional rigidity, being careful not to over tighten Nylon screw.
5. Install your mount as described in the directions accompanying your mount.

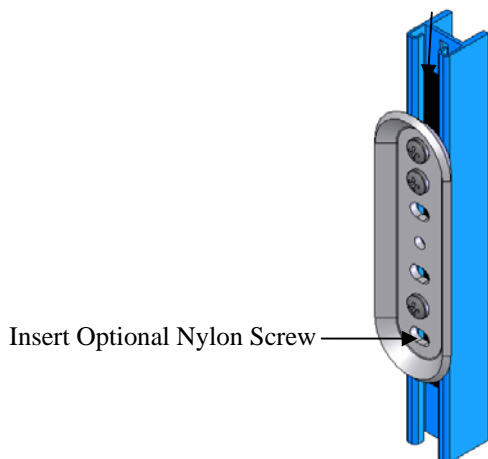
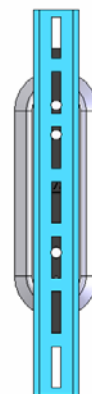

Figure 2



Back View
Showing
Screw
Alignment
with Hole

Figure 3