



# INSTALLATION INSTRUCTIONS

## OFB-175

### STEELCASE TABLE ADAPTER

Prior to assembly, unpack carton completely and verify contents.

If you are missing any of the following components, please contact Customer Service at 1-800/582-6480

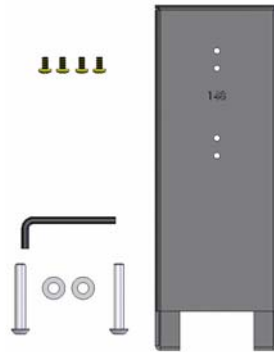

- (1) Bracket, Table Adapter
- (2) Screw, button head, 5/16-18X2"

Figure 1

- (4) Screw, Phillips head, 10-24X3/8"
- (2) Washer
- (1) Key, hex, 3/16"

### BEFORE PROCEEDING, READ INSTALLATION INSTRUCTIONS COMPLETELY

NOTE: Suggested tools include a magnetic screwdriver.

1. Place table adapter bracket over the mounting slots at the rear of the table (see Figure 2).
2. Insert two 5/16-18X2" button head screws through the mounting slots and, using the 3/16" hex key (provided), secure the table adapter bracket to the table.
3. Secure the mounting bracket (supplied with your mounting assembly) to the table adapter bracket using four 10-24X3/8" Phillips head, screws (see Figure 2 and Figure 3).

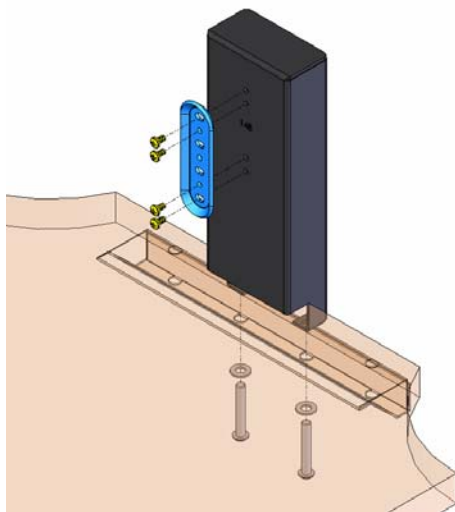

Figure 2

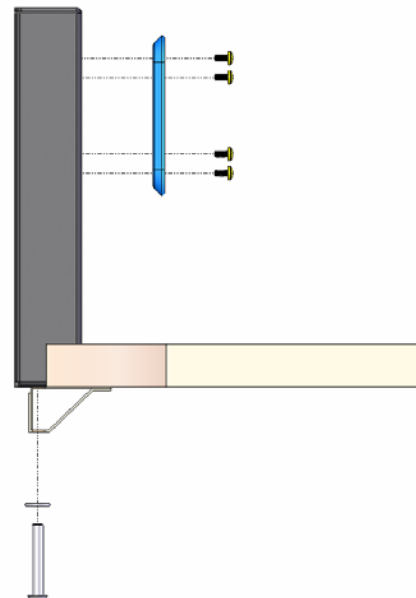

Figure 3