

---

# INSTALLATION INSTRUCTIONS

---

## PSS COVER KIT

### PAC-110

The PAC-110 accessory is designed for use with the Chief swivel stand.

Unpack and check contents:

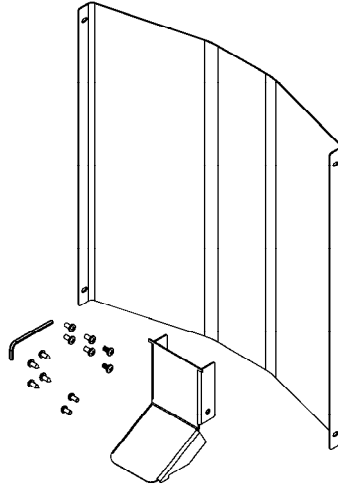

Figure 1. Parts

- |                                  |                                      |
|----------------------------------|--------------------------------------|
| (1) COVER, Back                  | (2) SCREW, Pan Head, 10-24 X 3/8"    |
| (1) COVER, Front                 | (4) SCREW, 10-24 X 3/8" Self Tapping |
| (4) SCREW, Security, Sheet Metal | (2) SCREW, 10-24 X 3/8" Security     |
|                                  | (1) KEY, Hex Head, Security          |

#### INSTALLATION INSTRUCTIONS

1. With display removed from stand, secure front cover to swivel stand as shown using two 10-24 screws or two 10-24 security screws (see Figure 2).

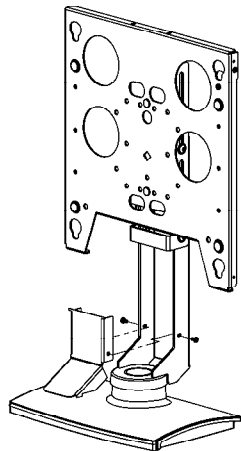

Figure 2. Front Cover Installation

**NOTE:** On smaller screens, you may need to raise the front plate to route cables through channel behind the front cover. If cables are too thick, the display and front plate may be taken off and reinstalled to allow cables to pass behind front cover.

- Secure back cover to back of stand as shown using four 10-24 self-tapping screws or four security sheet metal screws (see Figure 3).

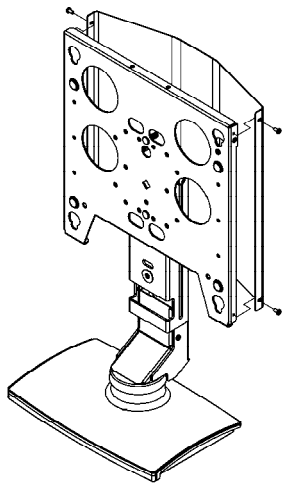

Figure 3. Back Cover Installation

- Install display on stand (see PSS instructions).