



INSTALLATION INSTRUCTIONS

PSB-2190

PLASMA DISPLAY MOUNTING BRACKET

Prior to assembly, unpack carton completely and verify contents.

If you are missing any of the following components, please contact Customer Service at 1-800/582-6480

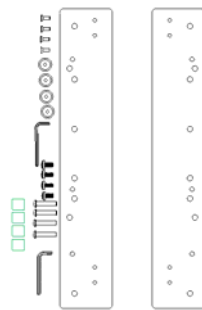

Figure 1

- (1) Plasma Static Mount Left Bracket
- (4) Mounting Buttons
- (4) M6 X 12 mm Phillips Cap Screws
- (4) .68 x .39 x .625 Nylon Spacers
- (1) M4 Allen Key

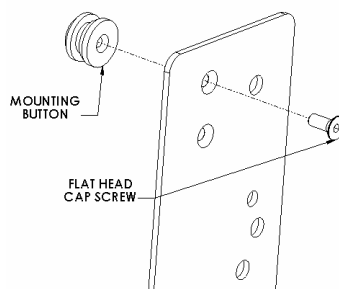

Figure 2

ATTACH MOUNTING BUTTONS
USING THESE HOLES

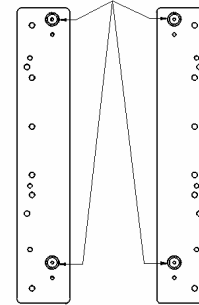

Figure 3

- (1) Plasma Static Mount Right Bracket
- (4) 10-24 Flat head Cap Screws
- (4) M6 x 30mm Button Head Cap Screws
- (1) 1/8" Allen Key

BEFORE PROCEEDING, READ INSTALLATION INSTRUCTIONS COMPLETELY

CAUTION! PLASMA DISPLAYS ARE EXTREMELY FRAGILE.

1. Using a 10-24 flat head cap screw inserted from chamfered hole side of bracket, secure mounting button, with chamfered hole of mounting button (larger surface) facing bracket, to bracket (four places) (see Figure 2 & Figure 3).
2. Align hole pattern on brackets with pattern on back of Plasma Display. Attach using the M6 x 12mm cap screws (see Figure 5). If a media box or tuner is located on back of screen, place nylon spacers over mounting holes and attach with M6 x 30mm button head cap screws (see Figure 4).
3. With the aid of another person, lift Plasma Display up to the Chief Mount, aligning buttons of mounting brackets with slots in the Chief Mount.
4. Lower safety catch on the Chief Mount to secure Plasma Display, making sure catch is completely engaged.

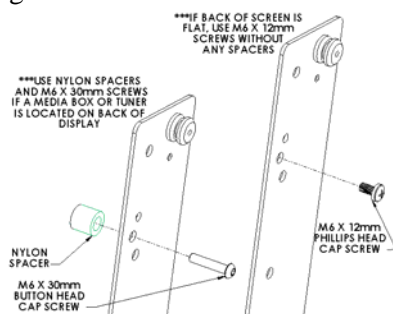

Figure 4

ATTACH BRACKETS TO BACK OF DISPLAY
USING THESE HOLES

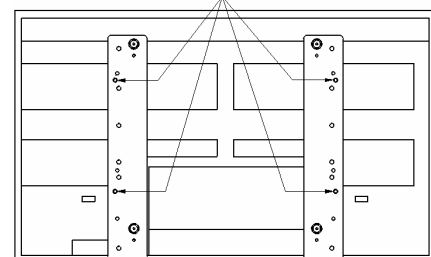

Figure 5