



SLB-720 HANGER BRACKET

FOR INFOCUS LP 720, LP 725, LP 730,

Prior to assembly, unpack carton and verify contents.
For security installation, use security hardware package inside the ALL-POINTS™ Security Kit. Follow the instructions below for attaching the bracket to the projector using either standard hardware or security hardware.
If you are missing any of the following components, please contact Customer Service at 1-800-582-6480

- | | | | |
|-----|---------------|-----|-------------------------|
| (1) | SLB-720 Plate | (3) | M4 x 8mm Machine Screws |
| (6) | Thumb Nuts | (3) | M4 Flat washers |

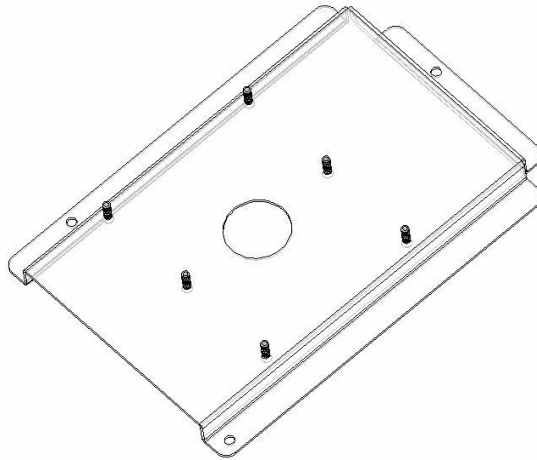

INSTALLATION INSTRUCTIONS

1. Carefully turn projector upside down and place on work surface.
2. Place the SLB-720 Plate onto the projector bottom and align three (3) .23 diameter holes with the threaded inserts in the bottom of the projector. Using the M4 machine screws and M4 flat washers, attach plate to the projector at these three places. Tighten moderately.
3. See RPA and/or Smart-Lift™ Instructions.

CHIEF MANUFACTURING INC. 1-800-582-6480, Fax: 1-877-894-6918, Email: chief@chiefmfg.com