

OPERATING INSTRUCTIONS

MODEL: SLEU/SLEU2 PROJECTOR LIFT

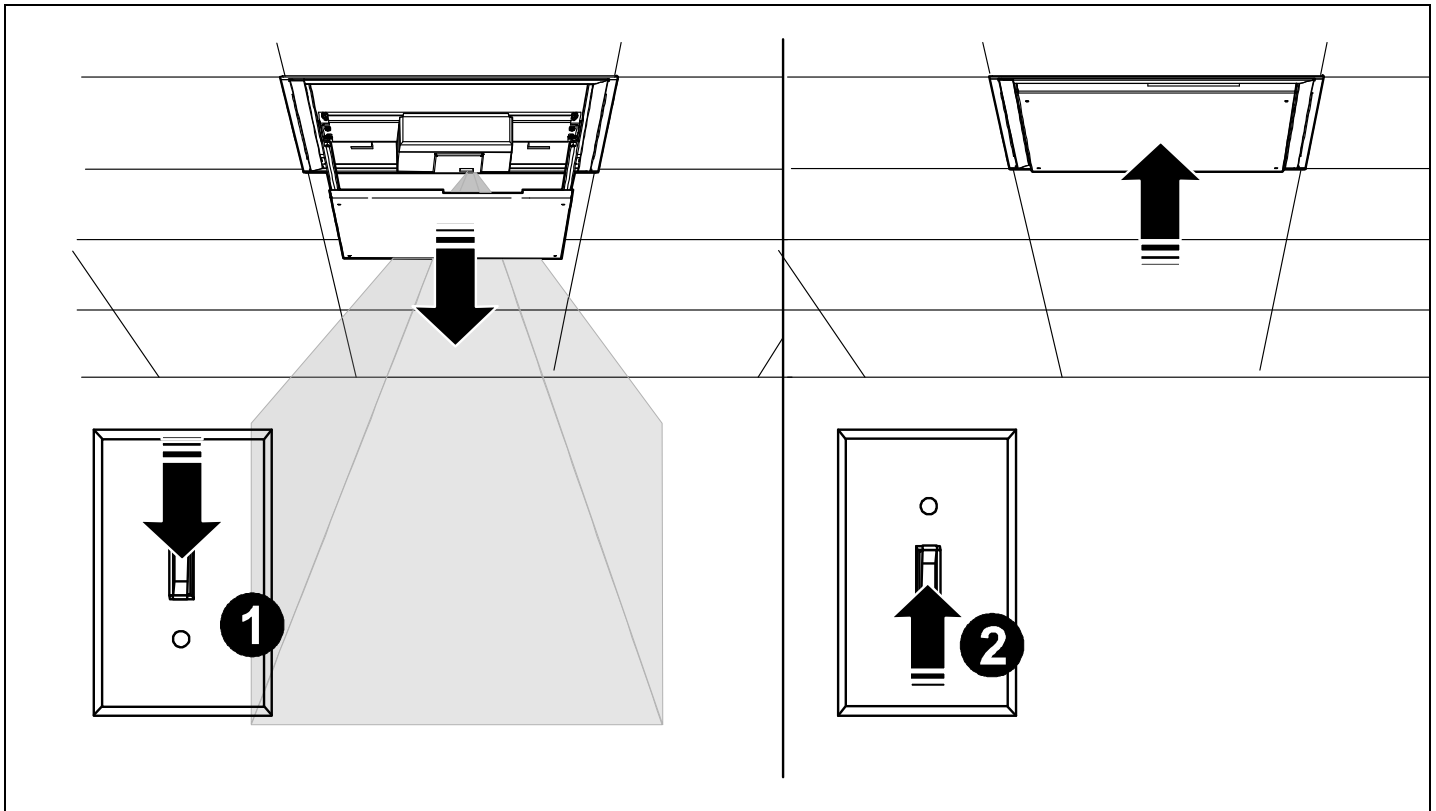

OPERATION:



WARNING: IMPROPER USE CAN LEAD TO EQUIPMENT FAILURE CAUSING SERIOUS PERSONAL INJURY AND DAMAGE TO EQUIPMENT! There are NO user serviceable parts within the SLEU lift. If lift fails to operate properly immediately contact a Chief Customer Services Representative by calling 1-800-582-6480.

1. Move control switch to the DOWN position to lower projector lift.
2. Move control switch to the UP position to raise projector lift.

Chief® is a registered trademark of Milestone AV Technologies. All rights reserved.

Milestone AV Technologies, and its affiliated corporations and subsidiaries (collectively, "Milestone"), intend to make this manual accurate and complete. However, Milestone makes no claim that the information contained herein covers all details, conditions or variations, nor does it provide for every possible contingency in connection with the installation or use of this product. The information contained in this document is subject to change without notice or obligation of any kind. Milestone makes no representation of warranty, expressed or implied, regarding the information contained herein. Milestone assumes no responsibility for accuracy, completeness or sufficiency of the information contained in this document.

OPERATING INSTRUCTIONS

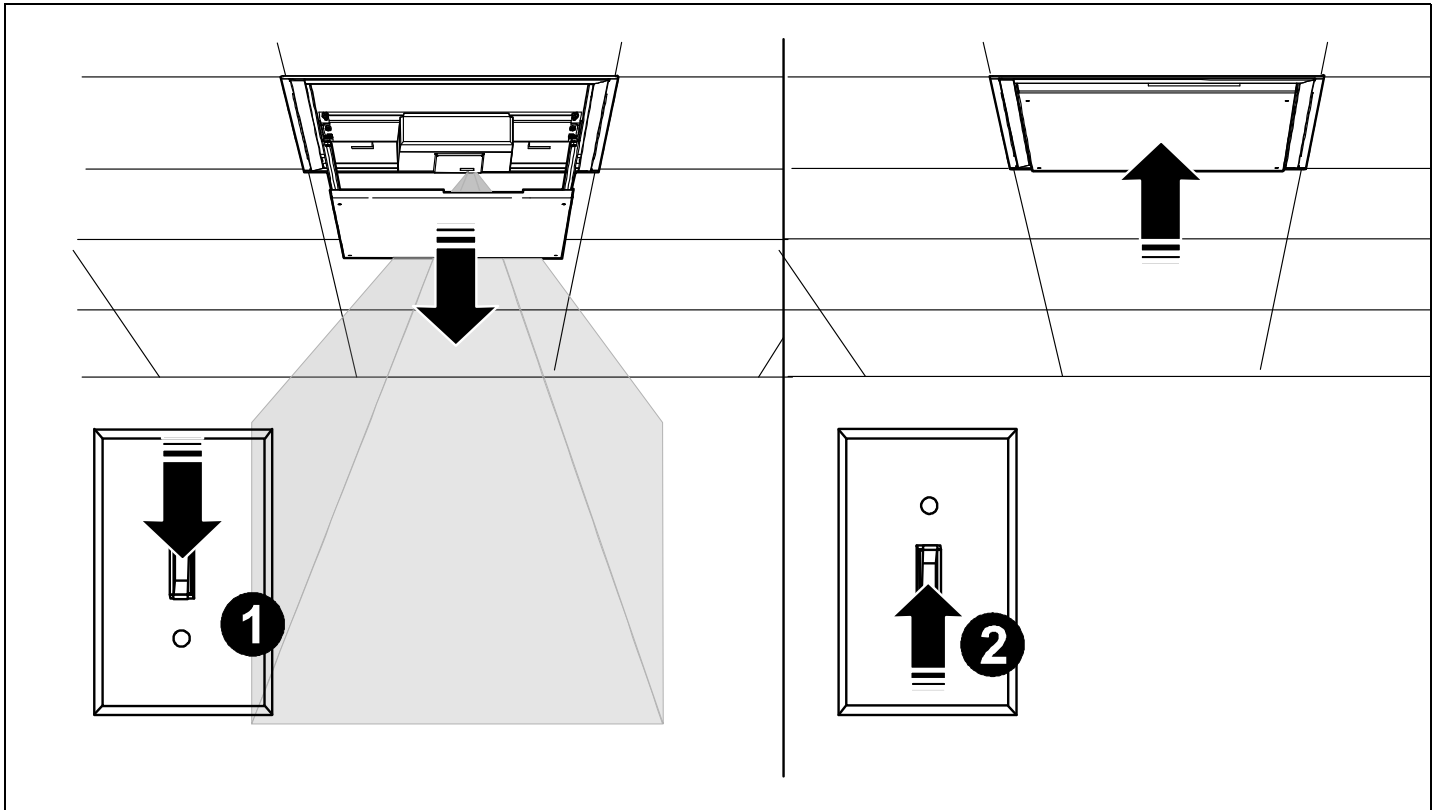

⚠ AVISO: SI NO SE UTILIZA CORRECTAMENTE, EL EQUIPO PODRÍA CAERSE Y CAUSAR GRAVES DAÑOS PERSONALES O MATERIALES. En el interior del elevador SLEU NO hay ninguna pieza que pueda reparar el usuario. Si el elevador no funciona correctamente, póngase inmediatamente en contacto con un representante del Departamento de Atención al Cliente de Chief Manufacturing llamando al número 1-800-582-6480.

1. Mueva el interruptor de control a la posición DOWN (ABAJO) para bajar el elevador del proyector.
2. Mueva el interruptor de control a la posición UP (ARRIBA) para subir el elevador del proyector.

Milestone AV Technologies, and its affiliated corporations and subsidiaries (collectively, "Milestone"), intend to make this manual accurate and complete. However, Milestone makes no claim that the information contained herein covers all details, conditions or variations, nor does it provide for every possible contingency in connection with the installation or use of this product. The information contained in this document is subject to change without notice or obligation of any kind. Milestone makes no representation of warranty, expressed or implied, regarding the information contained herein. Milestone assumes no responsibility for accuracy, completeness or sufficiency of the information contained in this document.

OPERATING INSTRUCTIONS

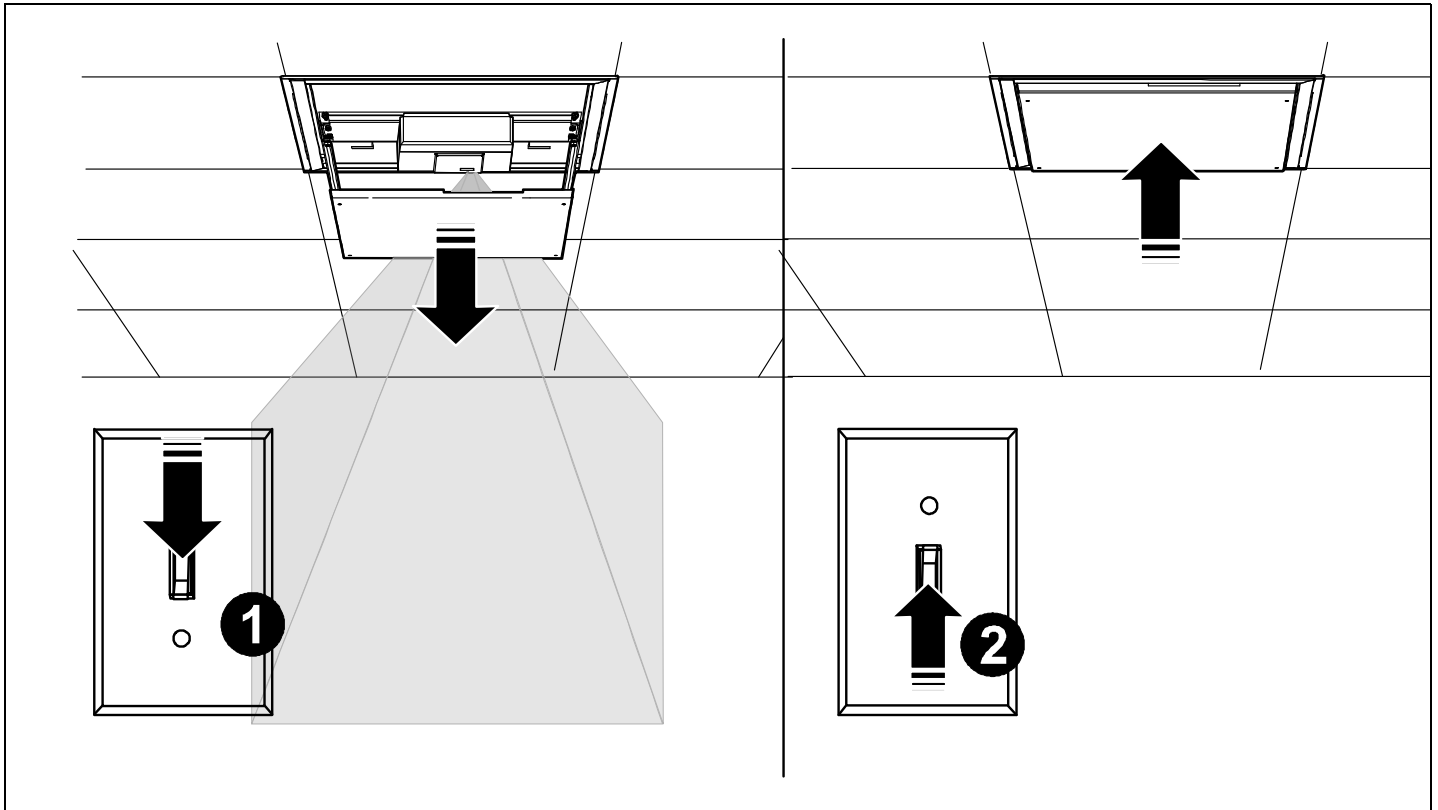

⚠️ WARNUNG: EINE UNSACHGEMÄSSE VERWENDUNG KANN ZUM VERSAGEN DER GERÄTE FÜHREN, WAS SCHWERE KÖRPERVERLETZUNGEN UND SCHÄDEN AN DEN GERÄTEN ZUR FOLGE HAT! Im SLEU-Lift befinden sich keine vom Benutzer zu wartenden Teile. Wenn der Lift nicht ordnungsgemäß funktioniert, wenden Sie sich umgehend an einen Kundendienstvertreter von Chief unter der Nummer 1-800-582-6480.

1. Den Steuerschalter nach UNTEN (DOWN) stellen, um den Projektorlift abzusenken.
2. Den Steuerschalter nach OBEN (UP) stellen, um den Projektorlift hochzufahren.

Milestone AV Technologies, and its affiliated corporations and subsidiaries (collectively, "Milestone"), intend to make this manual accurate and complete. However, Milestone makes no claim that the information contained herein covers all details, conditions or variations, nor does it provide for every possible contingency in connection with the installation or use of this product. The information contained in this document is subject to change without notice or obligation of any kind. Milestone makes no representation of warranty, expressed or implied, regarding the information contained herein. Milestone assumes no responsibility for accuracy, completeness or sufficiency of the information contained in this document.

OPERATING INSTRUCTIONS

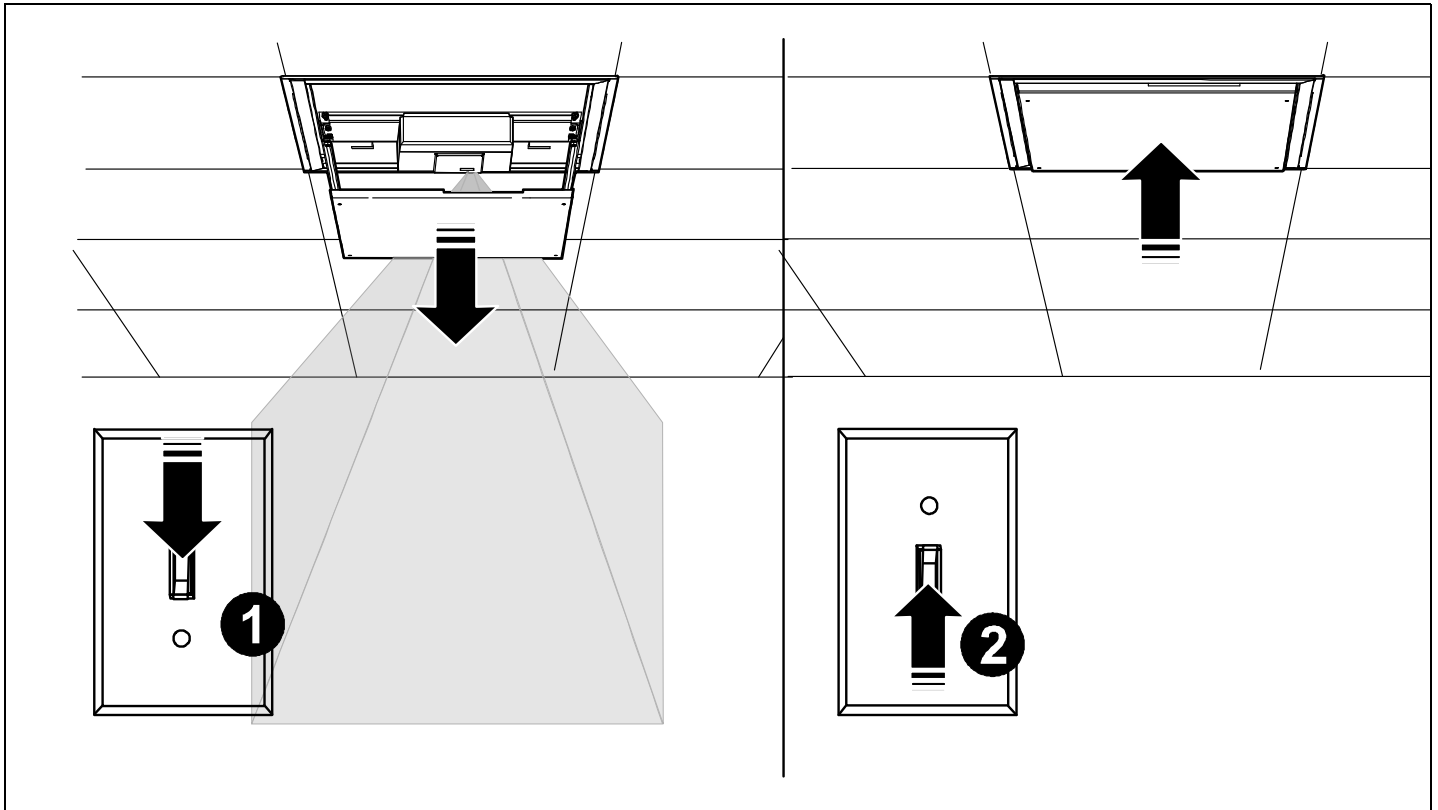

⚠️ ADVERTÊNCIA: O USO INADEQUADO PODE CONDUZIR A FALHA DO EQUIPAMENTO E A CONSEQUENTES LESÕES PESSOAIS GRAVES E DANOS NO EQUIPAMENTO! NÃO existem peças no interior do elevador SLEU que possam ser reparadas pelo utilizador. Se o elevador não estiver operacional, contacte imediatamente um representante de assistência ao cliente da Chief através do telefone 1-800-582-6480.

1. Desloque o interruptor de controlo para a posição DOWN (BAIXO) para descer o elevador do projector.
2. Desloque o interruptor de controlo para a posição UP (CIMA) para subir o elevador do projector.

Milestone AV Technologies, and its affiliated corporations and subsidiaries (collectively, "Milestone"), intend to make this manual accurate and complete. However, Milestone makes no claim that the information contained herein covers all details, conditions or variations, nor does it provide for every possible contingency in connection with the installation or use of this product. The information contained in this document is subject to change without notice or obligation of any kind. Milestone makes no representation of warranty, expressed or implied, regarding the information contained herein. Milestone assumes no responsibility for accuracy, completeness or sufficiency of the information contained in this document.

OPERATING INSTRUCTIONS

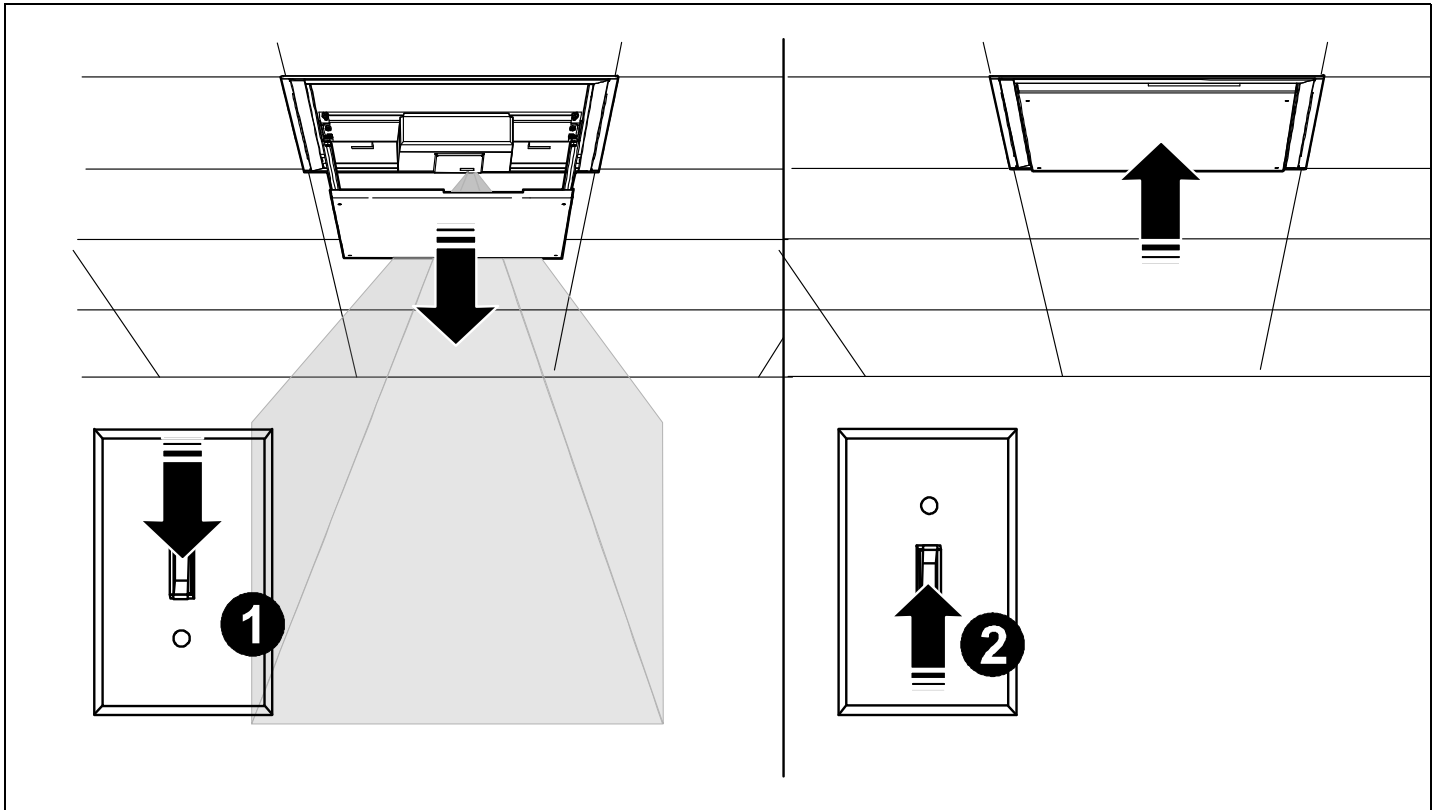

⚠ AVVERTENZA: UN USO INADEGUATO PUÒ PROVOCARE UN GUASTO, CON CONSEGUENTI LESIONI GRAVI O DANNI ALL'APPARECCHIATURA! La piattaforma elevatrice SLEU NON contiene componenti che l'utente può riparare personalmente. Se non dovesse funzionare correttamente, rivolgersi immediatamente all'assistenza clienti Chief telefonando al numero verde USA 1 800 582 6480.

1. Portare l'interruttore in posizione DOWN (GIÙ) per abbassare la piattaforma elevatrice del proiettore.
2. Portare l'interruttore in posizione UP (SU) per alzare la piattaforma elevatrice del proiettore.

Milestone AV Technologies, and its affiliated corporations and subsidiaries (collectively, "Milestone"), intend to make this manual accurate and complete. However, Milestone makes no claim that the information contained herein covers all details, conditions or variations, nor does it provide for every possible contingency in connection with the installation or use of this product. The information contained in this document is subject to change without notice or obligation of any kind. Milestone makes no representation of warranty, expressed or implied, regarding the information contained herein. Milestone assumes no responsibility for accuracy, completeness or sufficiency of the information contained in this document.

OPERATING INSTRUCTIONS

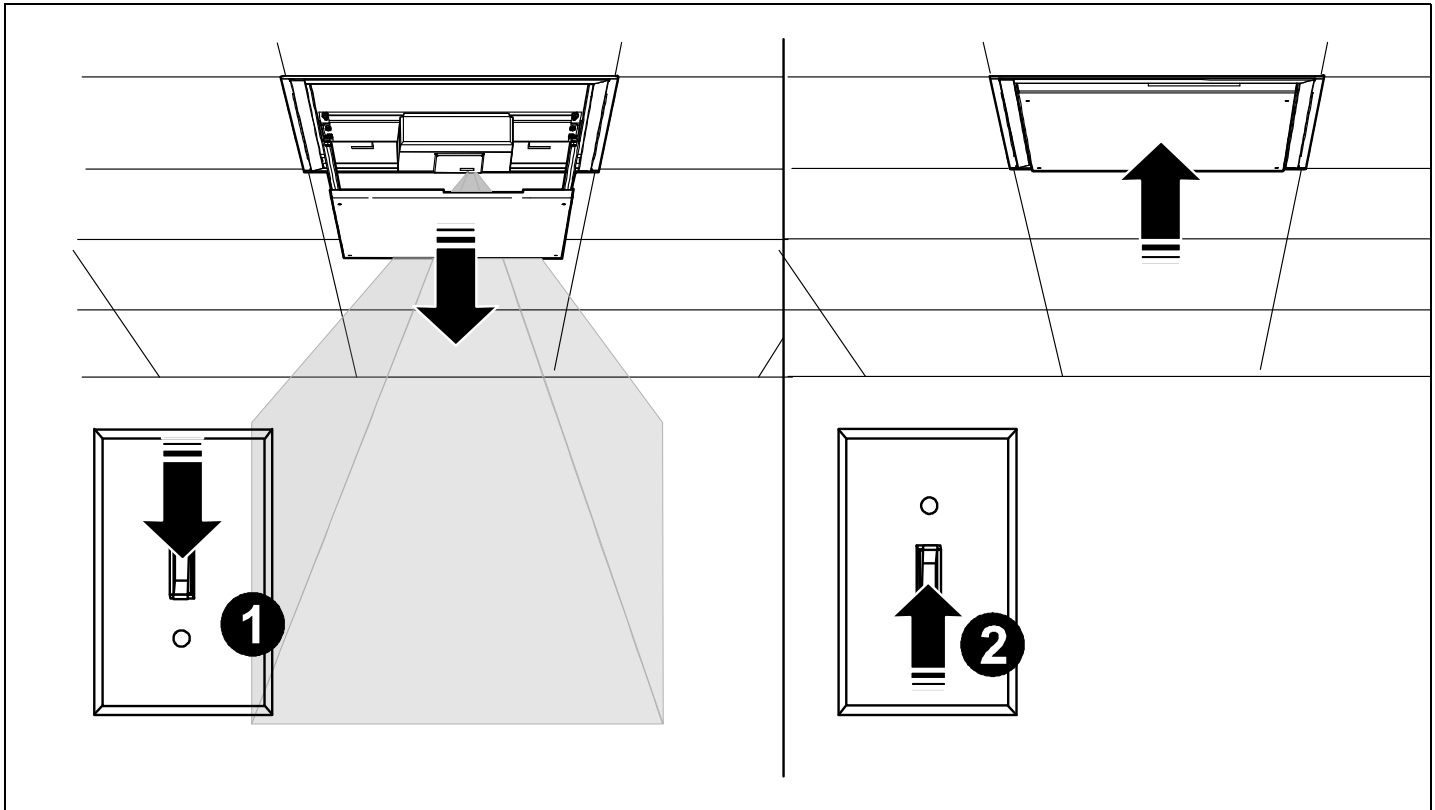

⚠ WAARSCHUWING: ONJUIST GEBRUIK KAN LEIDEN TOT HET FALEN VAN DE APPARATUUR EN ERNSTIG PERSOONLIJK LETSEL EN SCHADE AAN DE APPARATUUR VEROORZAKEN! Er zijn GEEN onderdelen in de SLEU Lift waar de gebruiker iets aan kan doen. Indien de lift niet goed werkt moet u onmiddellijk contact opnemen met een Hoofd Klantendienst Vertegenwoordiger door te bellen naar het nummer 1-800-562-6480.

1. Schuif de regelschakelaar naar BENEDEN (DOWN) om de projectorlift omlaag te brengen.
2. Schuif de regelschakelaar OMHOOG (UP) om de projector lift omhoog te brengen.

Milestone AV Technologies, and its affiliated corporations and subsidiaries (collectively, "Milestone"), intend to make this manual accurate and complete. However, Milestone makes no claim that the information contained herein covers all details, conditions or variations, nor does it provide for every possible contingency in connection with the installation or use of this product. The information contained in this document is subject to change without notice or obligation of any kind. Milestone makes no representation of warranty, expressed or implied, regarding the information contained herein. Milestone assumes no responsibility for accuracy, completeness or sufficiency of the information contained in this document.

OPERATING INSTRUCTIONS

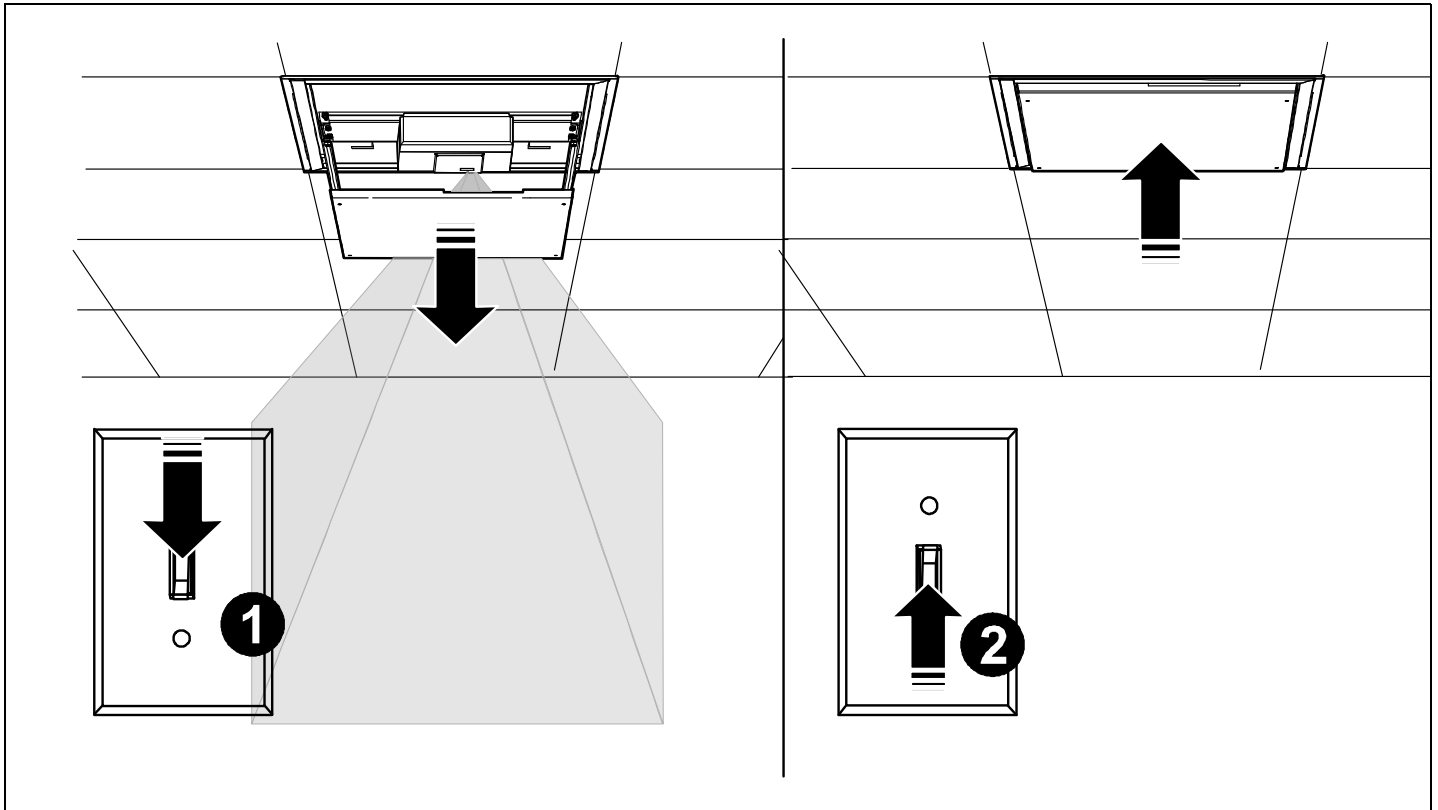

⚠ WARNING: AVERTISSEMENT : UNE UTILISATION ABUSIVE PEUT CAUSER LA DÉFAILLANCE DE L'ÉQUIPEMENT ET PEUT CAUSER DES BLESSURES GRAVES ET RÉSULTER EN DES DOMMAGES À L'ÉQUIPEMENT ! Il n'y a aucune pièce pouvant être échangée par l'utilisateur dans l'élévateur SLEU. Si l'élévateur ne fonctionne pas correctement contactez immédiatement un membre du service à la clientèle de Chief en appelant le 1-800-582-6480.

1. Mettre l'interrupteur de contrôle sur la position DOWN (EN BAS) pour abaisser l'élévateur du projecteur.
2. Mettre l'interrupteur de contrôle sur la position UP (EN HAUT) pour élever l'élévateur du projecteur.

Milestone AV Technologies, and its affiliated corporations and subsidiaries (collectively, "Milestone"), intend to make this manual accurate and complete. However, Milestone makes no claim that the information contained herein covers all details, conditions or variations, nor does it provide for every possible contingency in connection with the installation or use of this product. The information contained in this document is subject to change without notice or obligation of any kind. Milestone makes no representation of warranty, expressed or implied, regarding the information contained herein. Milestone assumes no responsibility for accuracy, completeness or sufficiency of the information contained in this document.

