

SANUS SYSTEMS

THE UNION OF FORM AND FUNCTION Assembly Instructions for Model: VMCA5b-01

Thank you for choosing a Sanus Systems VisionMount™ accessory. The 100° Angled Ceiling Plate is designed for ease of installation with any height of ceiling. By using any length of standard NPT 1½" pipe threaded both ends, you can extend the height capabilities to meet your needs.

Safety Warning: If you do not understand these directions, or have any doubts about the safety of the installation, please call a qualified contractor or contact Sanus at 800.359.5520 or www.sanus.com. Check carefully to make sure that there are no missing or defective parts. Our customer service representatives can quickly assist you with installation questions and missing or damaged parts. Replacement parts for products purchased through authorized dealers will be shipped directly to you. Never use defective parts. Improper installation may cause damage or serious injury. Do not use this product for any purpose that is not explicitly specified by Sanus Systems. Sanus Systems can not be liable for damage or injury caused by incorrect mounting, incorrect assembly, or incorrect use. Please call Sanus Systems before returning products to the point of purchase.

WARNING: IMPROPER INSTALLATION MAY RESULT IN SERIOUS PERSONAL INJURY!

When mounting Sanus accessories, the structural system and mounting method MUST be capable of supporting 5 times the combined weight of the total installation. The maximum weight to be installed on the Unistrut adapter is 500 pounds (226.4Kg).

Parts List:

- | | |
|-------------------------------------|--------------------------------------|
| (1) Cathedral Ceiling Plate CMA-395 | (1) Coupler Assembly |
| (1) 5/16"-18 X 3/8" Set Screw | (1) ½"-13 X 4" Hex Head Bolt |
| (1) ½"-13 Nylock Nut | (2) 3/8"-16 X 5/8" Hex Machine Screw |
| (2) 7/8" Washer | (1) 5/32" Hex Key |

INSTALLATION INSTRUCTIONS

1. Set coupler in place in the center of ceiling plate and slide ½"-13 X 4" hex head bolt through both parts (see Figure 1). Secure using ½"-13 Nylock nut.
2. Install two 3/8"-16 X 5/8" hex machine screws, with ¾" washers, through adjusting slots on either side of bracket into holes in the coupler assembly (see Figure 1). Do not tighten.
3. Adjust coupler to desired angle and tighten two 3/8"-16 X 5/8" hex machine screws.
4. Install extension pipe in coupler and secure using the 5/16"-18 X 3/8" set screw (see Figure 2).

Figure 1 - Assembly

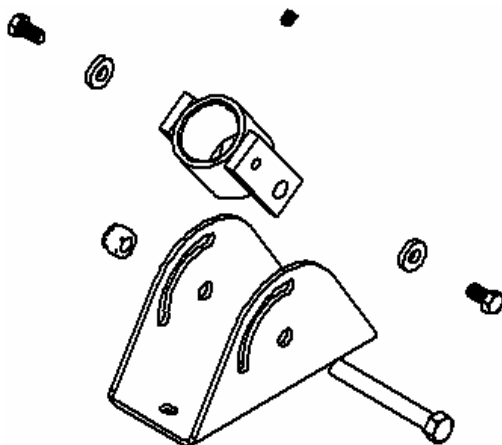

Figure 2 - Assembly

